



DEXTER[®]
LAUNDRY

**USE THE BLUE TABS LOCATED ON THE
RIGHT AND LEFT SIDES OF THE FOLLOWING
DOCUMENT TO ADVANCE TO EACH SECTION.**

Kits, Assemblies, & Common Parts

DN30X2NC-15
DN50X2NC-15

| Description | 30x2 | 50x2 |
|-------------------------------------------------|--------------|--------------|
| LINER-BAFFLE,RIGHT(DDBD50 & newer),PTD | | 9354-013-002 |
| LINER-BAFFLE,LEFT(DDBD50 & newer),PTD | | 9354-014-002 |
| Kit - A to C series Conversion, Black, 120v | 9732-307-002 | 9732-307-002 |
| Kit - A to C series Conversion, Blue, 120v | 9732-307-001 | 9732-307-001 |
| LP to Natural Conversion Kit for White Rodgers | 9732-142-004 | 9732-142-004 |
| LP to NG Conversion Kit for 9857-134-001 & -002 | 9732-142-002 | 9732-142-002 |
| Temperature Probe | 9501-006-001 | |
| Controls Black | 9857-198-003 | 9857-198-001 |
| Controls Blue | 9857-198-001 | 9857-198-003 |
| Coin Drop | 9021-092-002 | 9021-092-002 |
| Optical Sensor | 9801-099-001 | 9801-099-001 |
| Coin Drop Screws | 9545-053-002 | 9545-053-002 |
| Ignition Control Box | 9857-182-001 | 9857-116-003 |
| Electrode Assembly, Ignition | 9875-002-003 | 9875-002-003 |
| Thermostat, Hi-Limit | 9576-203-002 | 9576-203-002 |
| Thermostat, Overtemp | 9576-207-008 | 9576-207-008 |
| Fuseholder | 9200-001-002 | 9200-001-002 |
| Fuse | 8636-018-001 | 8636-018-001 |
| Motor Run Relay | 5192-299-001 | 5192-299-001 |
| Transformer, Ignition | 8711-011-001 | 8711-011-001 |
| Lint Screen 15/18 by 15/18 .010 Wire | 9555-057-002 | 9555-057-008 |
| Air Flow Switch | 9539-461-009 | 9536-461-009 |
| Door Switch | 9539-487-001 | 9539-487-001 |
| Motor Belt | 9040-077-001 | 9040-076-009 |
| Tumbler Belt | 9040-073-009 | 9040-073-011 |
| Tension Arm Complete | 9861-022-001 | 9861-022-001 |
| Spider/Trunnion | 9568-015-001 | 9568-013-001 |
| Door Handle | 9244-093-001 | 9244-082-001 |
| Cleanout Duct Assembly 8" | 9973-034-001 | 9973-034-001 |



Section 6: Parts Data 30# Stack

Cabinet Group - 30 lbs

| Key | Part Number | Description | Quantity |
|-----|--------------|--------------------------------------------------------------|----------|
| * | 9960-256-032 | Door Assy., Loading Complete-Wht | 2 |
| * | 9960-256-034 | Door Assy., Loading Complete-SS | 2 |
| 1 | 9960-255-008 | Door Ring Only, Loading-SS(ring only) | 2 |
| 1 | 9960-319-007 | Door Ring Only, Loading-Black (after serial D1.22290.005) .. | 2 |
| 2 | 9982-280-014 | Plate Assy., Hinge (Wht) No Pin | 2 |
| 2 | 9982-280-012 | Plate Assy., Hinge (SS) No Pin..... | 2 |
| * | 9545-012-015 | Screw, Hinge to Door | 8 |
| * | 8640-413-002 | Nut, Hinge to Door | 8 |
| 3 | 9212-002-003 | Glass, Door | 2 |
| 4 | 9206-413-001 | Gasket, Glass (Black)..... | 2 |
| * | 9548-117-000 | Support, Door Glass | 2 |
| 5 | 9206-420-003 | Gasket, Outer Rim (Black) | 2 |
| 6 | 9244-082-001 | Handle, Loading Door | 2 |
| * | 9545-018-017 | Screw, Handle 1/4-20 x 3/8 | 2 |
| * | 9531-033-001 | Stud, Door Catch | 2 |
| * | 8640-413-001 | Nut, Hex | 2 |
| * | 8640-413-003 | Nut, Acorn | 2 |
| * | 9086-015-002 | Catch, Loading Door | 2 |
| * | 8638-190-009 | Pop Rivet for mtg. catch | 4 |
| * | 8641-582-019 | Lockwasher..... | 4 |
| * | 8640-399-001 | Spring Nut | 6 |
| * | 8640-442-001 | Expansion Nut (After Serial D1.21180.036)..... | 6 |
| 7 | 9989-569-006 | Panel Assy., Front- Lower (Wht) | 1 |
| 7 | 9989-569-004 | Panel Assy., Front- Lower (SS) | 1 |
| 8 | 9989-568-006 | Panel Assy., Front- Upper (Wht) | 1 |
| 8 | 9989-568-004 | Panel Assy., Front- Upper (SS) | 1 |
| 9 | 9545-008-014 | Screw, Phillips 10B x 1 3/4"..... | 14 |
| 9 | 8541-585-001 | Washer finish | 6 |
| * | 8640-399-001 | Nut, Spring | 12 |
| * | 8640-442-001 | Expansion Nut (After Serial D1.21180.036)..... | 12 |
| 10 | 9544-072-002 | Strap, Hinge | 2 |
| * | 9345-012-028 | Screw, Hinge to Panel | 8 |
| 11 | 9545-052-001 | Screw, Door to Hinge Strap (Special Black Type) | 2 |
| * | 8641-436-003 | Washer, Fiber | 2 |
| * | 9472-001-013 | Cabinet Touch Up Paint (White) | 1 |



Cabinet Group - 30 lbs (continued)

| Key | Part Number | Description | Quantity |
|-----|--------------|------------------------------------------------------------------|----------|
| 14 | 9141-175-002 | Escutcheon, Upper | 1 |
| 15 | 9435-026-001 | Trim, Overlay-Upper (Blue)..... | 1 |
| 15 | 9435-034-001 | Trim, Overlay-Upper (Black) | 1 |
| 16 | 9141-176-002 | Escutcheon, Lower | 1 |
| 17 | 9435-020-001 | Trim, Overlay-Lower (Blue)..... | 1 |
| 17 | 9435-028-001 | Trim, Overlay-Lower Black) | 1 |
| 18 | 9412-154-001 | Nameplate Stack Dryer Express (Blue)..... | 1 |
| 18 | 9412-167-001 | Nameplate Stack Dryer Express (Black) | 1 |
| 21 | 8650-026-002 | Lock, Thumb Turn | 2 |
| 22 | 9857-187-001 | Controls Assy, Electronic Mounted With Membrane Switch (Blue) . | 1 |
| 22 | 9857-187-003 | Controls Assy, Electronic Mounted With Membrane Switch (Black) 1 | |
| 22 | 9801-096-001 | Membrane Switch Assy (Blue) | 1 |
| 22 | 9801-105-001 | Membrane Switch Assy (Black)..... | 1 |
| 23 | 8650-012-003 | Lock and Key, Control #6324 | 1 |
| 24 | 9501-006-002 | Sensor Temp Control..... | 2 |
| 24 | 9486-137-002 | Retainer - Push On..... | 2 |
| 25 | 9866-004-010 | Lint Drawer Assembly (Blue) | 2 |
| 25 | 9866-004-013 | Lint Drawer Assembly (Black)..... | 2 |
| 25 | 9435-003-009 | Overlay trim, lint dwr, upper/lower (Blue) | 1 |
| 25 | 9435-029-002 | Overlay trim, lint dwr, upper/lower (Black)..... | 1 |
| * | 9545-020-009 | Screw..... | 10 |
| * | 9532-143-001 | Felt Seal (back of lint screen assembly) | 2 |
| * | 9181-036-001 | Lint Screen Assembly ONLY (no front) | 2 |
| * | 9555-057-002 | Replaceable Lint Screen Only | 2 |
| * | 9095-044-001 | Cam, Lock Lint Drawer | 2 |
| * | 9545-008-001 | Lint Screen Strap Hold Down Screws 10Bx 1/4 | 32 |
| * | 9627-885-001 | Harness, Electronic Control | 1 |
| * | 9095-044-001 | Cam, Lock Control..... | 1 |
| * | 6292-006-007 | Key 6324 only for Computer..... | 2 |
| * | 9627-886-001 | Harness, Heat Sensor | 1 |
| * | 9277-041-011 | Insulation Cabinet Cover | 1 |
| * | 9209-037-002 | Grommet, 3/16 ID | 2 |
| * | 8544-006-001 | Leg, Leveling 1/2" | 4 |
| * | 8545-060-002 | Leveling Leg Wrench | 1 |
| * | 9074-261-001 | Cover, Cabinet (Top)..... | 1 |
| * | 9732-102-011 | LP Kit for DDAD Dryers..... | 1 |
| * | 9732-243-001 | Stack Dryer Trunnion Puller..... | 1 |
| * | 9555-057-003 | Replaceable Lint Screen Fine Mesh Only | 1 |
| * | 9277-063-001 | Insulation-Front Panel-Top Half | 2 |
| * | 9277-063-002 | Insulation-Front Panel-Lower Half..... | 2 |
| * | 8640-276-002 | Wire Nut Connector Grey..... | 4 |
| * | 9527-007-002 | Standoff Wire Saddle..... | 8 |
| * | 9544-041-002 | Strap - Bead Tie..... | 1 |

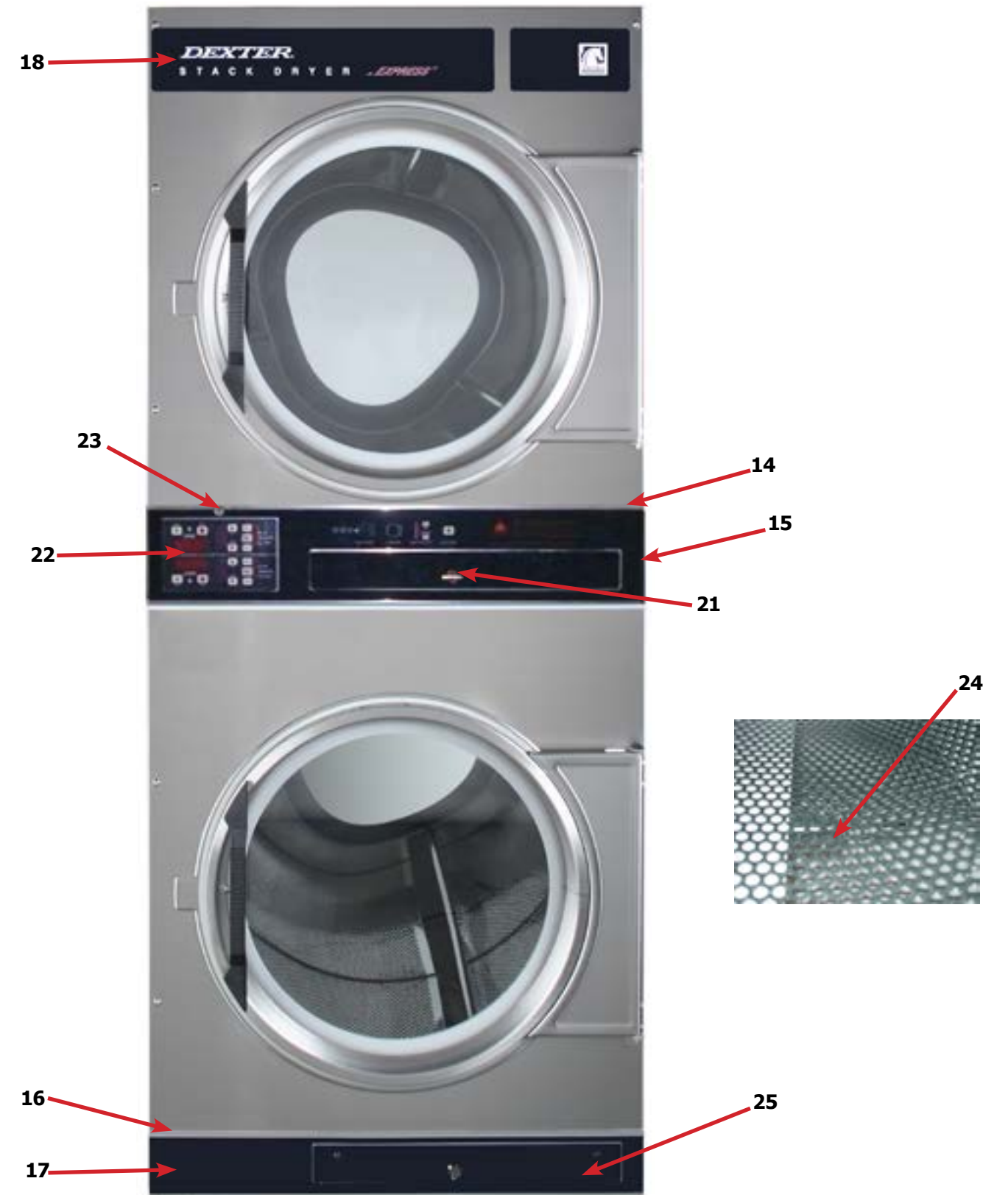

Door Switch Group - 30 lbs

| Part Number | Description | Quantity |
|--------------|---------------------|----------|
| 9539-487-001 | Door Switches | 2 |



Hinge Plate Cover

| | | | |
|---|--------------|-------------------------------------|---|
| 1 | 9074-341-002 | Cover-Hinge, Black..... | 2 |
| 2 | 8636-018-001 | Screw-TRHDCR, 10B x 3/8, Black..... | 4 |

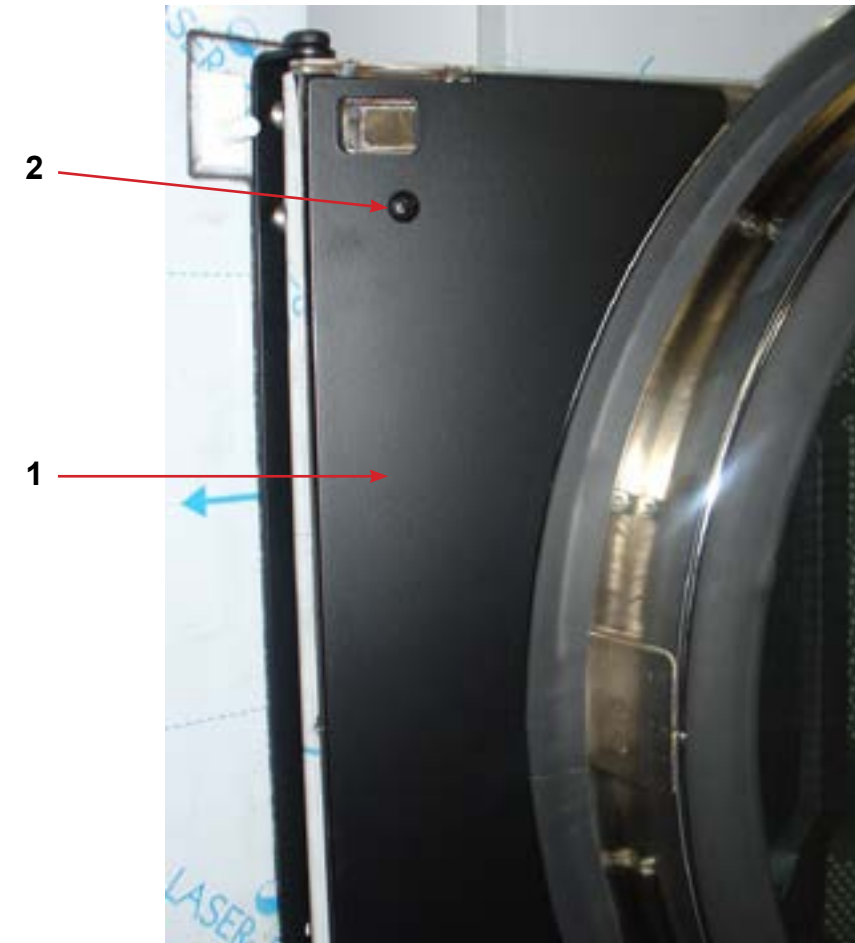

Bearing Housing Group

| Key | Part Number | Description | Quantity |
|-----|--------------|-----------------------------------------------------------------|----------|
| * | 9803-160-003 | Bearing Housing Complete Assy (Includes bearings & Spacer)..... | 1 |
| 1 | 9241-161-002 | Housing, Bearing..... | 1 |
| * | 9036-130-001 | Bearing, Ball, Front | 1 |
| * | 9538-139-002 | Spacer, Bearing..... | 1 |
| 2 | 9036-130-001 | Bearing, Ball, Rear | 1 |
| 3 | 9545-049-002 | Screw-Wizlock, 3/8-24x3/4 | 4 |
| 4 | 8640-400-002 | Nut, 5/16-18..... | 4 |
| 5 | 9545-049-001 | Screw, 3/8-24x1..... | 2 |
| 6 | 8640-415-002 | Nut, 3/8-24..... | 2 |
| * | 9538-139-002 | Shim, Tumbler | AR |

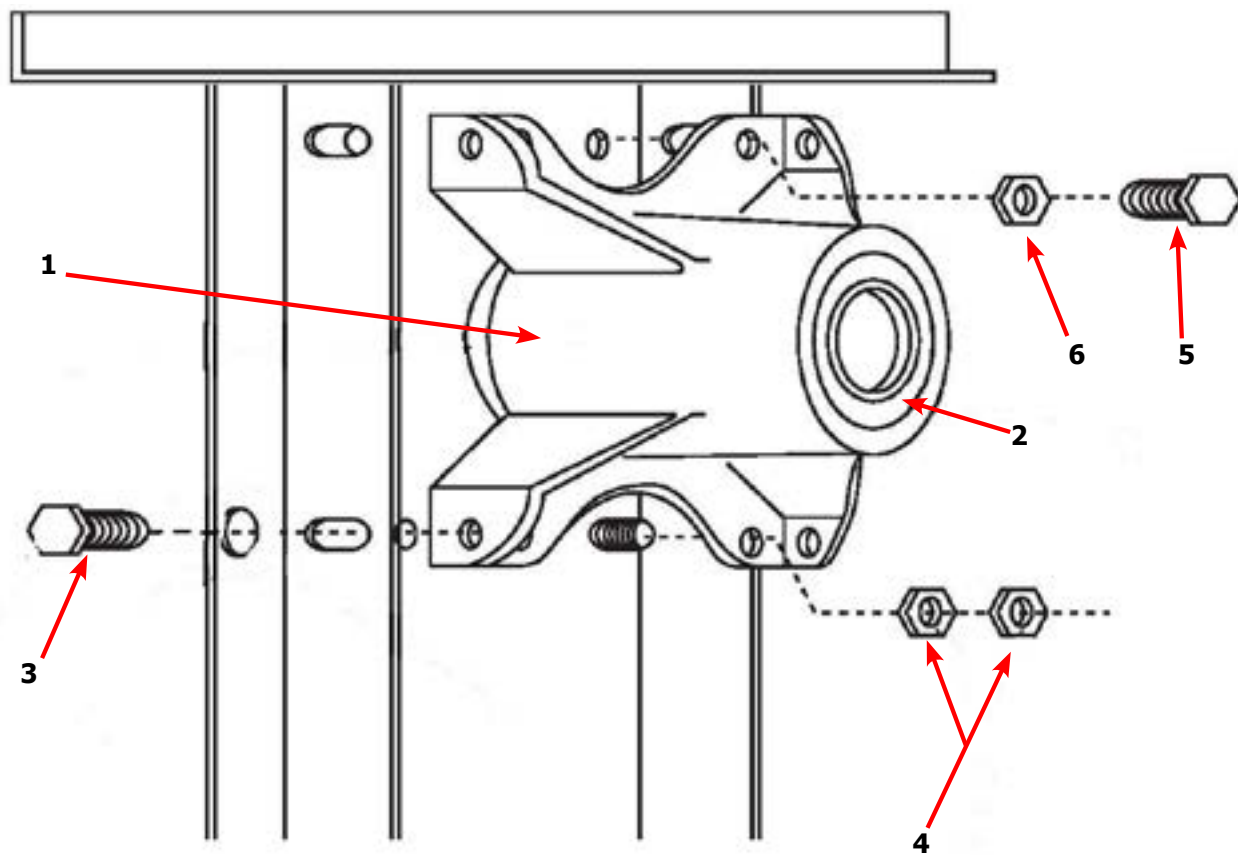

Tumbler Group

| Key | Part Number | Description | Quantity |
|-----|--------------|-------------------------------------------------------|----------|
| * | 9848-147-001 | Tumbler Assy Complete W/Spider (GALV)..... | 1 |
| * | 9848-147-002 | Tumbler Assy Complete W/Spider (SS & Galv front)..... | 1 |
| 1 | 9848-146-001 | Tumbler Assy (Galvanized)..... | 1 |
| 1 | 9848-146-002 | Tumbler Assy (Stainless Galvanized front) | 1 |
| 2 | 9497-019-003 | Rod, Tumbler..... | 3 |
| 3 | 8641-554-001 | Washer, Special..... | 3 |
| 4 | 9552-013-003 | Shim | AR |
| 5 | 9568-015-001 | Spider Assy..... | 1 |
| 6 | 8640-415-004 | Nut, Wiz Lock | 3 |
| 7 | 9538-164-001 | Spacer-Shaft..... | 1 |
| 8 | 9487-234-005 | Tolerance Ring..... | 1 |
| 9 | 9908-049-002 | Pulley, Driven..... | 1 |
| 10 | 8641-581-026 | Washer -Flat..... | 1 |
| 11 | 8641-582-016 | LockWasher - IntTooth, 1" | 1 |
| 12 | 9545-017-009 | Screw, 1/2-13x1 1/4..... | 1 |

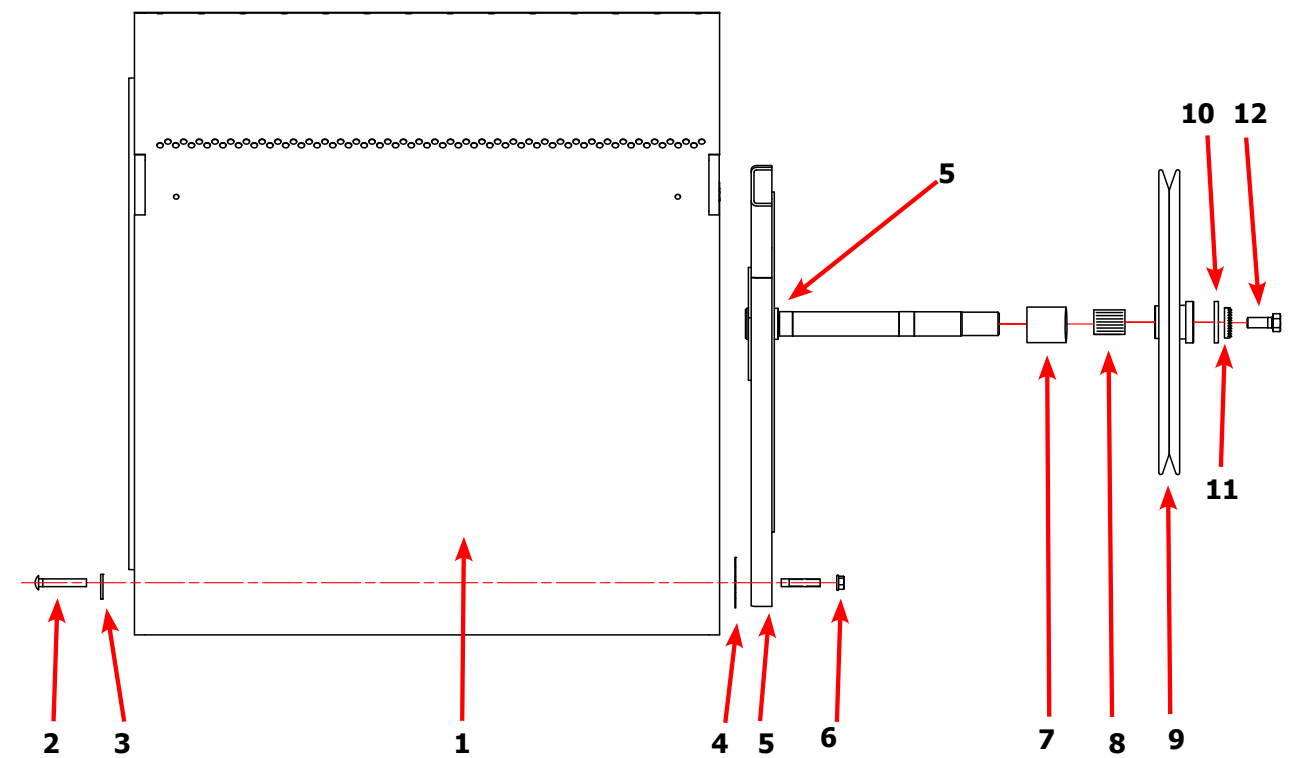

Burner Housing Group - 30 lbs

| Key | Part Number | Description | Quantity |
|-----|--------------|------------------------------------------------------------|----------|
| 1a | 9452-730-001 | Service Burner Plate Front..... | 2 |
| 1 | 9452-729-001 | Service Plate baffle Recirculation Chamber Clean Out | 2 |
| 2 | 9545-008-001 | Screw | 16 |
| 18 | 9003-220-001 | Angle, Burner Support | 2 |
| 17 | 9048-020-001 | Burner, Main | 4 |
| 4 | 9545-008-001 | Screw 10B x1/4" | 8 |
| 5 | 9875-002-003 | Electrode Assy, Ignition | 2 |
| 19 | 9545-045-001 | Screw, Electrode Mtg 8B x 1/4" | 4 |
| 7 | 9379-186-001 | Valve, Gas Shut Off (Optional) | 1 |
| 8 | 9857-192-001 | Control Assy, Gas | 2 |
| 9 | 9381-012-001 | Manifold, Assy 2 Part 1 Piece..... | 2 |
| 22 | 8615-104-038 | Pipe Plug in end of Burner Manifold | 2 |
| 11 | 9452-749-001 | Plate Assy, Hi-Limit Stat Ignitor | 2 |
| 12 | 9576-203-002 | Thermostat, Hi-Limit | 2 |
| 13 | 9074-329-001 | Cover, Hi-Limit Stat Ignitor | 2 |
| 15 | 9074-336-001 | Cover, Safety Stat | 2 |
| 16 | 9857-116-003 | Control, Ignition Fenwall (3 trybox) | 2 |
| * | 9803-229-001 | Housing Assembly, Burner | 2 |
| * | 9545-008-006 | Screw 10AB x 3/8" | 4 |
| * | 9545-991-001 | Panel, Back Burner Housing..... | 2 |
| * | 9425-069-023 | Orifice, Burner-Natural #125 | 4 |
| * | 9425-069-024 | Orifice, Burner-LP #49..... | 4 |
| * | 9039-915-001 | Bracket, Gas Control | 2 |
| * | 9545-008-006 | Screw | 4 |
| * | 9538-142-001 | Spacer, Hi-Limit | 4 |
| * | 9545-045-007 | Screw 8B x 3/4"..... | 4 |
| * | 9545-008-006 | Screw | 6 |
| * | 9576-207-008 | Thermostat, Safety Shutoff | 2 |
| * | 9545-008-006 | Screw | 4 |
| * | 9545-008-006 | Screw | 4 |
| * | 9550-173-001 | Shield, Burner Inlet | 1 |
| * | 9732-102-044 | Kit, LP Conversion (White Rodgers) | 2 |
| * | 9838-018-004 | Welded One Piece Gas Pipe Assembly | 1 |
| * | 9732-360-002 | Gas Pipe Assembly Replacement Kit..... | 1 |
| * | 9838-023-002 | Gas Pipe Assembly (After Serial)..... | 1 |
| * | 8615-120-001 | Fitting - 1/2 NPT Union Adapter | 1 |

^ Models built before 9/07

Burner Housing Group Photos - 30 lbs

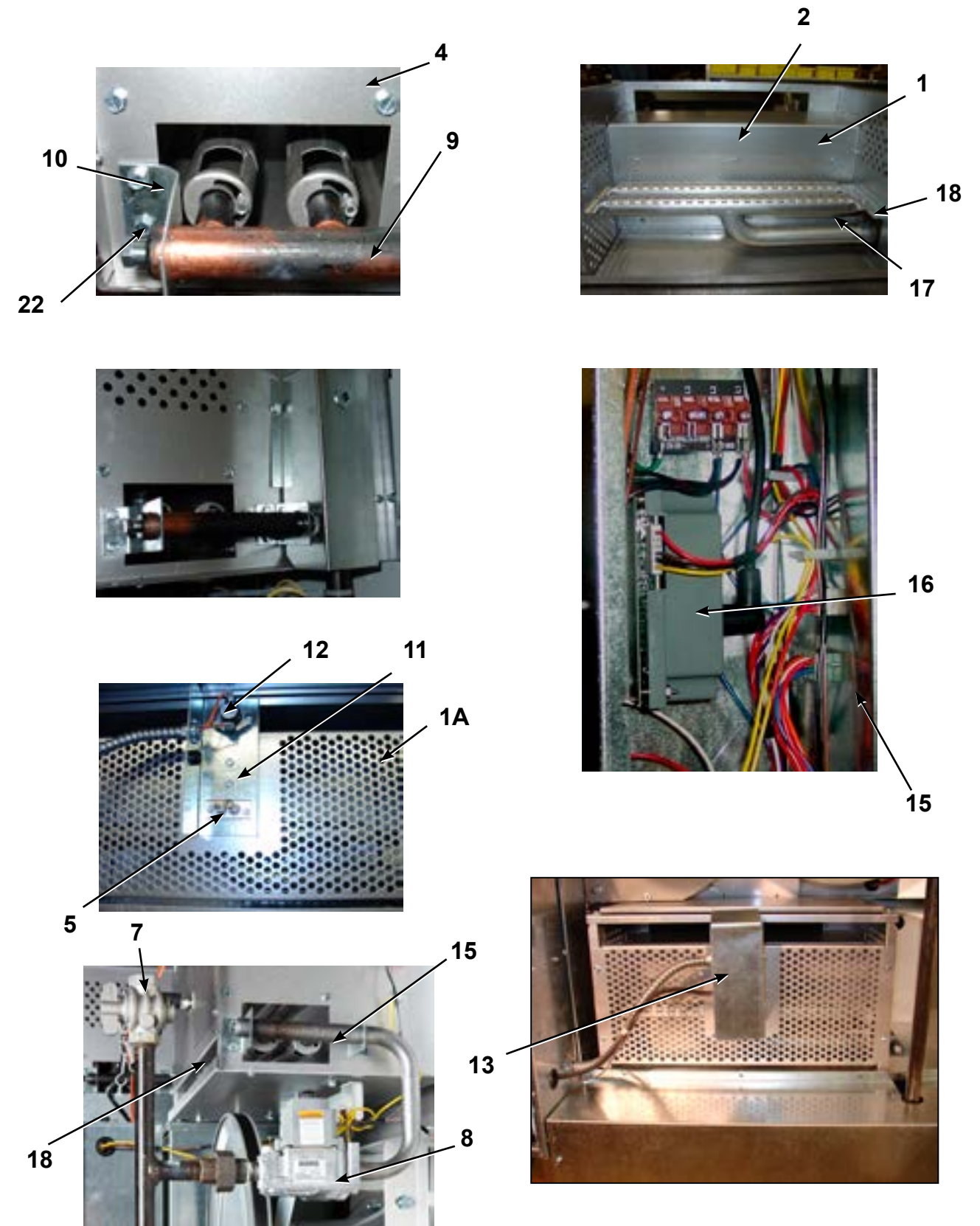

Rear View - 30 lbs

| Key | Part Number | Description | Quantity |
|-----|---------------|-----------------------------------------------------------|----------|
| * | 9627-861-001 | Wire Harness Overtemperature Switch..... | 2 |
| * | 9801-095-001 | Switch Assy, Air Flow | 2 |
| 1 | 9539-461-009 | Switch, Air Flow..... | 2 |
| 2 | 9029-174-001 | Bracket, Switch- Air Flow | 2 |
| 3 | 9008-007-001 | Actuator, Switch | 2 |
| 4 | 9451-169-002 | Pin, Cotter | 2 |
| 5 | 9545-020-001 | Screw 4-40 x 5/8" | 4 |
| * | 8640-401-001 | Nut, Special Twin .#4-40..... | 2 |
| * | 9550-169-003 | Shield, Switch..... | 2 |
| * | 9545-008-001 | Screw 10 Bx 1/4" | 6 |
| 7 | 9376-331-001 | Motor, Drive 5hp | 2 |
| * | 9732-202-026 | Motor, Drive Kit..... | 2 |
| * | 5191-108-003 | Run Capacitor..... | 2 |
| * | 5191-109-003 | Start Capacitor..... | 2 |
| 8 | 9452-740-001 | Plate, Motor Mtg..... | 2 |
| * | 9545-029-008 | Bolt 3/8" - 16 x 3/4"..... | 8 |
| * | 8641-582-003 | Lockwash Spring 3/8 | 8 |
| 9 | 9545-018-019 | Screw, Motor Plate to Back Assy. 1/4-20x 2 1/2 | 8 |
| 9 | 86411-582-007 | Lockwasher 1/4..... | 8 |
| 9 | 9538-163-006 | Spacer | 8 |
| 9 | 8641-581-017 | Flat Washer 1/4 x 7/8..... | 24 |
| 9 | 9209-086-002 | Rubber Grommet..... | 8 |
| * | 9538-166-006 | Grommet Spacers..... | 8 |
| * | 9545-028-013 | Screw, Set | 4 |
| 10 | 9962-017-002 | Back Assy, Blower Hsg..... | 2 |
| 26 | 9278-039-001 | Impeller, W/Set Screws..... | 2 |
| 11 | 9991-053-001 | Support Assy, Intermed. Pulley | 2 |
| 12 | 9545-029-010 | Bolt, Rd Hd 3/8-16 x 1 1/4..... | 6 |
| 13 | 9545-029-003 | Bolt, 3/8-16 x 1 1/2..... | 2 |
| 12 | 8640-415-004 | Nut Flange Wizioc 3/8" - 16 | 6 |
| 12 | 8641-581-035 | Washer, Flat..... | 6 |
| 14 | 9861-022-001 | Arm Assy-Tension, Complete | 2 |
| * | 8641-581-035 | Washer, Flat..... | 2 |
| 15 | 9487-200-003 | Ring-Retaining | 6 |
| 16 | 9908-039-004 | Pulley Assy, Intermediate with bronze flange bearing..... | 2 |
| * | 9036-145-002 | Bearing - Bronze Flange..... | 4 |
| 17 | 9908-040-001 | Pulley Driven | 2 |
| * | 9306-006-000 | Key Tumbler Shaft Woodcuff | 2 |
| * | 8640-222-000 | Nut Hex 1" - 14 | 2 |
| * | 8641-582-015 | Washer Lock | 2 |
| * | 9538-164-001 | Spacer, Shaft | 2 |
| 18 | 86A1-582-015 | Washer, Lock | 2 |
| 19 | 9040-077-001 | Belt, Drive- Motor..... | 2 |
| 20 | 9040-073-009 | Belt, Drive- Tumbler | 2 |
| 21 | 9534-319-002 | Spring, Tension | 2 |
| 22 | 9099-012-002 | Chain, Tension..... | 2 |
| 23 | 9248-022-002 | Hook, Tension | 2 |
| * | 9125-007-001 | Damper Inside Duct Exhaust Upper | 1 |
| 24 | 9451-146-001 | Pin, Damper Hinge | 2 |
| * | 8520-141-000 | Nut, Spring | 4 |
| * | 9425-007-002 | Damper, Inside Duct Exhaust Lower | 1 |
| * | 9545-008-026 | Screw #10B x 1/2..... | 6 |
| 25 | 9074-363-001 | Cover Duct Upper..... | 1 |
| * | 9074-364-001 | Cover Duct Lower..... | 1 |
| * | 9545-008-026 | Screw 10ABx 1/2"..... | 14 |
| 25 | 9973-033-001 | Heat Recirculation Assembly Duct..... | 2 |
| 27 | 9453-157-001 | Motor Pulley - Driver..... | 1 |
| * | 9029-173-001 | Bracket for Wire Harness Under Burner Housing..... | 2 |
| * | 9545-008-024 | Screw 10 AB x 3/8 | 58 |

Rear View Photos - 30 lbs

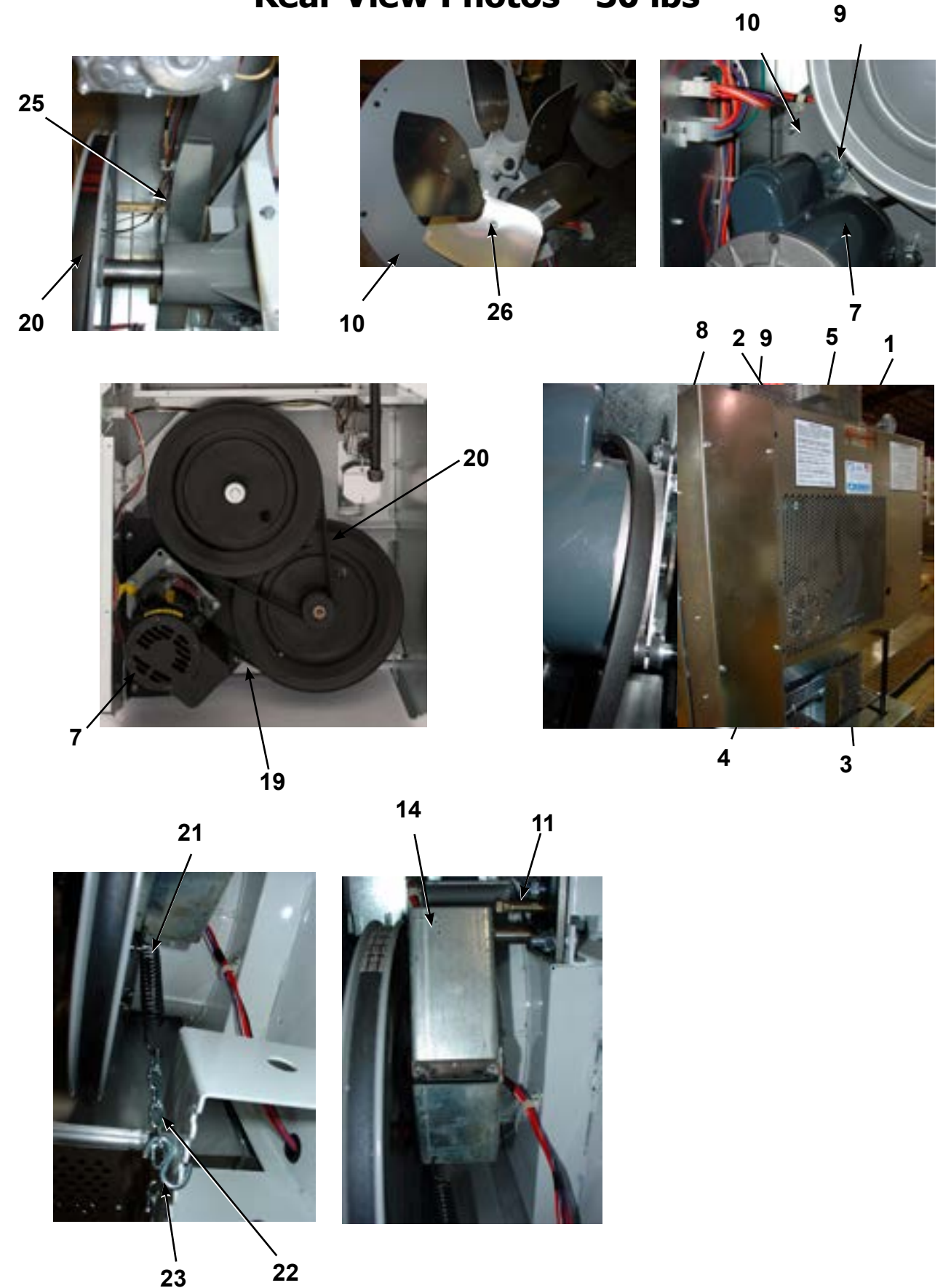

Rear Panel & Cover Group - 30 lbs

| Key | Part Number | Description | Quantity |
|-----|--------------|------------------------------------|----------|
| 1 | 9208-083-001 | Back Drive Guard Panel | 2 |
| * | 9545-008-024 | Screws, Guard..... | * |
| 2 | 9208-076-001 | Back Side Guard Panel Ass'y..... | 2 |
| 3 | 9074-365-001 | Cabinet (TOP COVER) | 1 |
| * | 8544-006-001 | Legs Leveling..... | 4 |
| 5 | 9545-008-024 | Screws 10 AB x 3/8..... | 4 |
| 6 | 9577-062-001 | Top Duct w/ Oval..... | 1 |
| 4 | 9108-117-001 | Electric Box Cover w/ Hinge..... | 1 |
| * | 9545-008-024 | Screws, Electronic Box Cover | 3 |

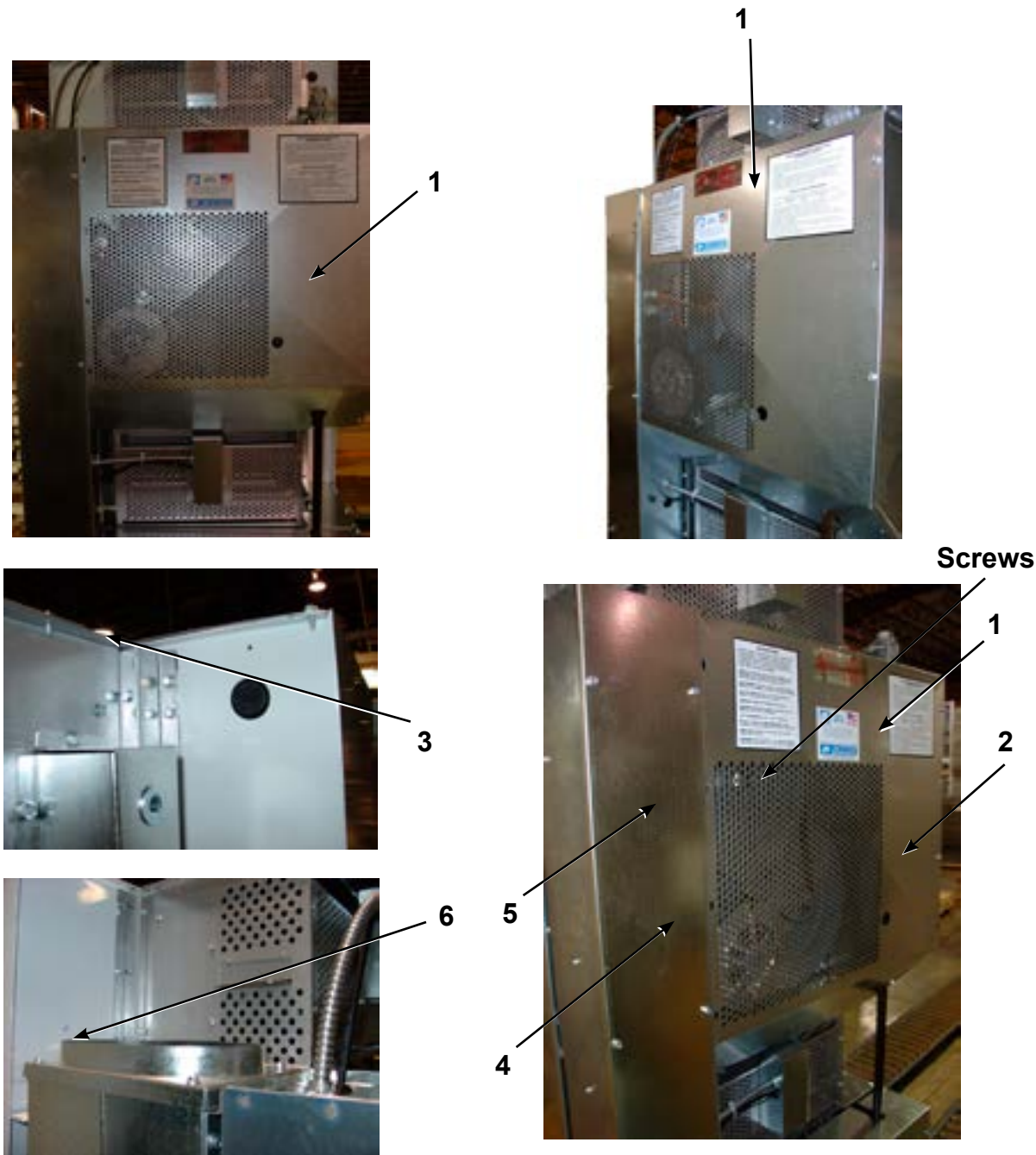

OPL Control Board - 30 lbs

| Key | Part Number | Description | Quantity |
|-----|--------------|--------------------------------------------|----------|
| 1 | 9801-096-001 | Control Assembly (Blue) | 1 |
| 1 | 9801-105-001 | Control Assembly (Black) | 1 |
| 2 | 9471-017-001 | PCB Control Board | 1 |
| 3 | 9471-018-001 | PCB Display Board | 1 |
| 4 | 9500-007-001 | Cable, Upper Control Long..... | 1 |
| 5 | 9500-007-002 | Cable, Lower Control Long..... | 1 |
| 6 | 9801-096-001 | Membrane Switch Assembly (Blue) | 1 |
| 6 | 9412-167-001 | Membrane Switch Assembly (Black)..... | 1 |
| 7 | 8636-024-001 | Fuse, 600ma / 250v | 2 |
| * | 9627-885-001 | Harness Main Control OPL Stack Dryer | 1 |

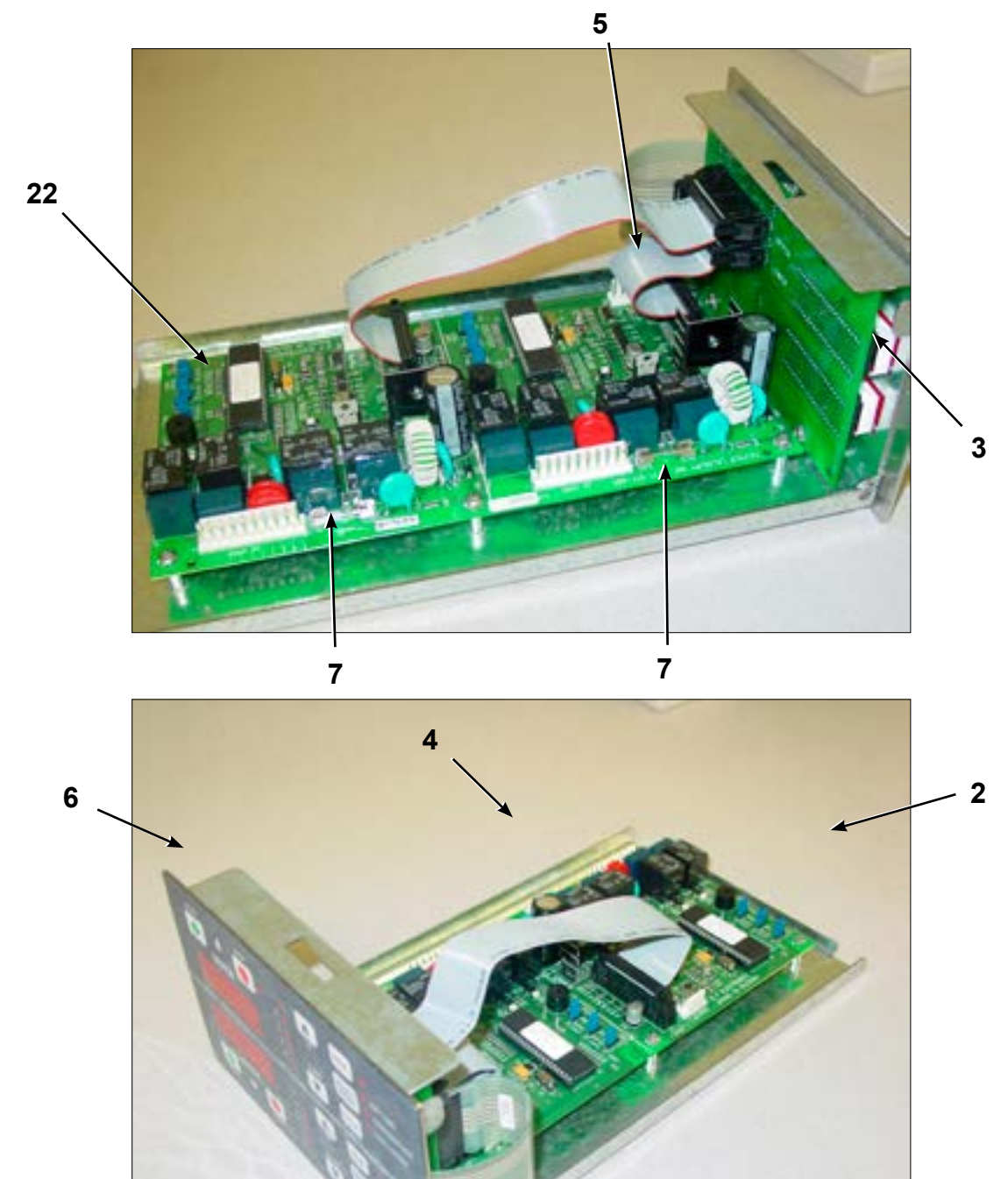

Control Assembly Group

| Key | Part Number | Description | Quantity |
|-----|--------------|---------------------------------------------------------------|----------|
| * | 9857-169-012 | Control Assembly Complete (all below included) | 1 |
| * | 9074-317-001 | Control Box Cover | 1 |
| 1 | 8653-068-003 | Connector Conduit 3/8" STR..... | 1 |
| 2 | 9558-029-003 | Strip Terminal Marker (Behind Input Power) to above #3..... | 1 |
| 3 | 9897-035-001 | Terminal Block Assembly Main Power Inlet | 1 |
| * | 9545-008-024 | Screws 10AB x 3/8" | 4 |
| * | 9627-859-003 | Wire Harness - Power Main | 1 |
| 4 | 8220-001-478 | Wire Assembly Green 7" | 1 |
| 5 | 9545-008-027 | Screw # 10-32 x 12 Green | 1 |
| * | 8641-582-006 | Lockwasher Ext Tooth #10..... | 1 |
| 6 | 9897-026-002 | Terminal Block Main Power Middle | 1 |
| 7 | 9897-026-001 | Terminal Block..... | 2 |
| * | 9545-045-012 | Screw #8 ABxl 2 for terminal block..... | 6 |
| 8 | 8711-013-001 | Transformer Control..... | 1 |
| * | 9545-008-024 | Screws 10AB x 3/8" | 4 |
| 9 | 9857-182-001 | Ignition Control | 2 |
| * | 9545-008-018 | Screws 10AB x 3/4" | 4 |
| 10 | 9631-403-009 | Wire Assembly High Voltage Upper..... | 1 |
| 11 | 9627-867-005 | Wire Harness Ignition Control Upper..... | 1 |
| 12 | 9631-403-008 | Wire Assembly High Voltage Lower..... | 1 |
| 13 | 9627-867-006 | Wire Harness Ignition Control Lower..... | 1 |
| * | 9053-067-002 | Bushing Wire 7/8"..... | 4 |
| 14 | 9200-001-002 | Fuseholder Assembly..... | 3 |
| * | 8636-018-001 | Fuse 1.5 Amp..... | 2 |
| * | 8636-018-004 | Fuse 2.5 Amp..... | 1 |
| 15 | 5192-299-001 | Relay Power | 2 |
| * | 9545-045-012 | Screws Power #8 AB x 1/2"..... | 4 |
| * | 8220-062-036 | Wire Assembly Red/Black 14" | 1 |
| * | 8220-062-037 | Wire Assembly Red/White 14" | 1 |
| 16 | 9627-864-006 | Wire Harness Motor Extension..... | 2 |
| 17 | 9527-007-001 | Stand Off - Wire Saddle / Arrowhead | 5 |
| 18 | 9627-863-001 | Wire Harness Main Extension Access Under Burner Housing | 4 |

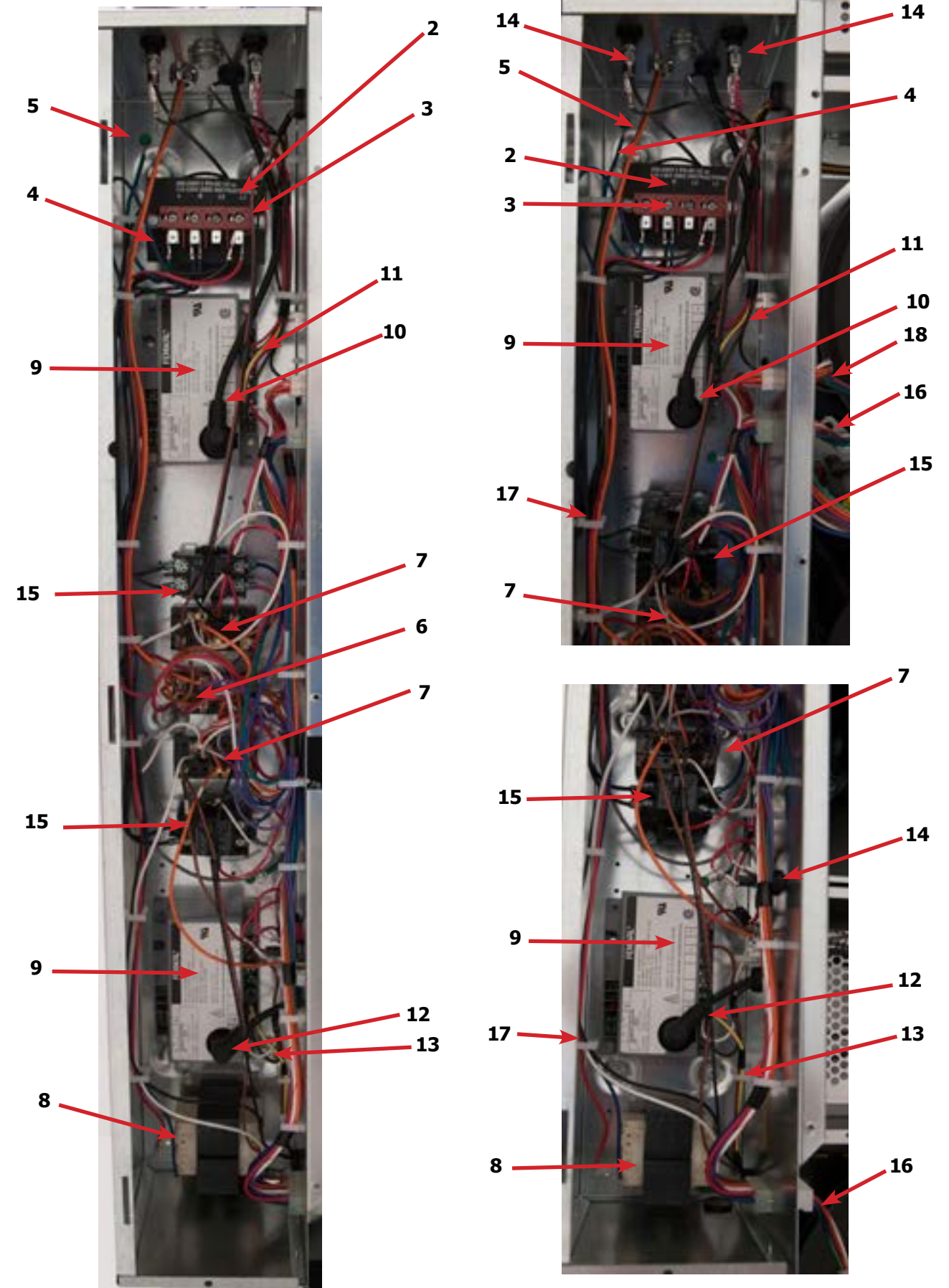
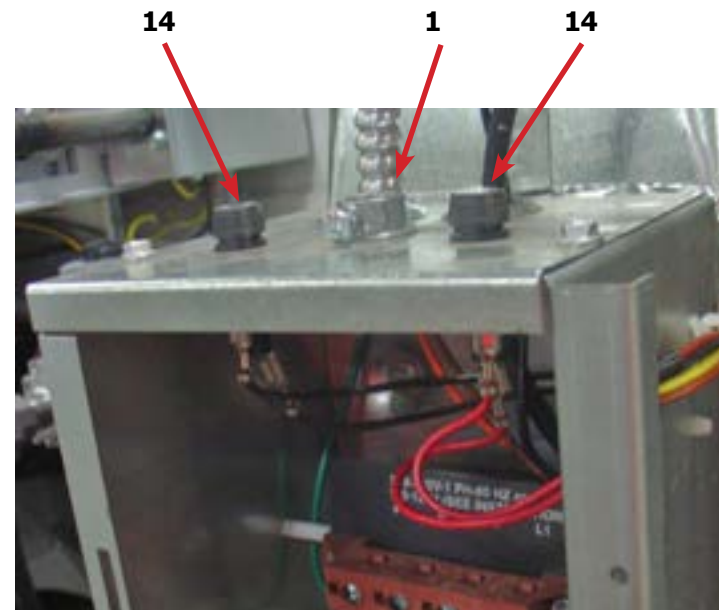

Wiring Group - 30 lbs

| Key | Part Number | Description | Quantity |
|-----|--------------|------------------------------------------------|----------|
| * | 9627-859-003 | Wiring Harness- Main Power | 1 |
| * | 9631-403-008 | Wire, Hi Voltage, Spark 18 1/2" Lower | 1 |
| * | 9631-403-009 | Wire High Voltage, Spark 29 1/4" Upper | 1 |
| * | 8502-645-001 | Label Instruction..... | 1 |
| * | 9506-353-001 | Wiring Label Schematic/Diagram..... | 1 |
| * | 9627-867-005 | Wire Harness Ignition Upper Low Voltage | 1 |
| * | 9627-867-006 | Wire Harness Ignition Lower Low Voltage | 1 |
| * | 9627-887-001 | Wire Harness Main Extension..... | 1 |
| * | 9627-864-006 | Wire Harness Motor Extension | 2 |
| * | 8220-062-036 | Wire Assembly Red/Black 14"..... | 1 |
| * | 8220-062-037 | Wire Assembly Red/White 14"..... | 1 |
| * | 8220-062-038 | Wire Assembly White 14"..... | 2 |
| * | 9627-861-001 | Wire Harness - Overtemp / Airswitch | 2 |
| * | 9627-885-001 | Wire Harness Main Controller | 1 |
| * | 9627-866-001 | Wire Harness - Heat Sensor | 1 |
| * | 8527-112-001 | Decal Lighting and Clearance..... | 1 |
| * | 8502-600-001 | Label Warning & Notice..... | 2 |
| * | 9506-651-001 | Schematic Label | 1 |
| * | 8514-259-001 | Owners Manual..... | 1 |
| * | 8507-330-001 | Instruction Transient Voltage Suppressor | 1 |
| * | 8507-350-001 | Instructions Dryer Install / Start | 1 |
| * | 8220-137-001 | Wire Assembly Green 24"..... | 1 |
| * | 8220-001-466 | Wire Assembly Yellow 4 7/8" Gas Valve | 2 |
| * | 8220-095-038 | Wire Assembly Orange 48"..... | 2 |
| * | 9506-651-001 | Wiring Diagram..... | 1 |
| * | 8220-095-040 | Wire Assembly Orange 24"..... | 1 |
| * | 8220-095-041 | Wire Assembly Brown 24"..... | 1 |
| * | 9053-067-002 | Bushings Wire 7/8"..... | 7 |
| * | 8220-095-039 | Wire Assembly Brown 48"..... | 1 |
| * | 9897-026-001 | Terminal Block..... | 2 |
| * | 9897-026-002 | Terminal Block..... | 2 |
| * | 9200-001-002 | Fuse Holder..... | 2 |
| * | 8636-018-001 | Fuse 1.5 A..... | 2 |
| * | 5192-298-002 | Relay, Power 24 VAC | 2 |
| * | 9897-035-001 | Terminal Block Power 4 Pole..... | 1 |
| * | 9558-029-003 | Strip Marker, Terminal | 1 |



Section 7:

Parts Data
50# Stack

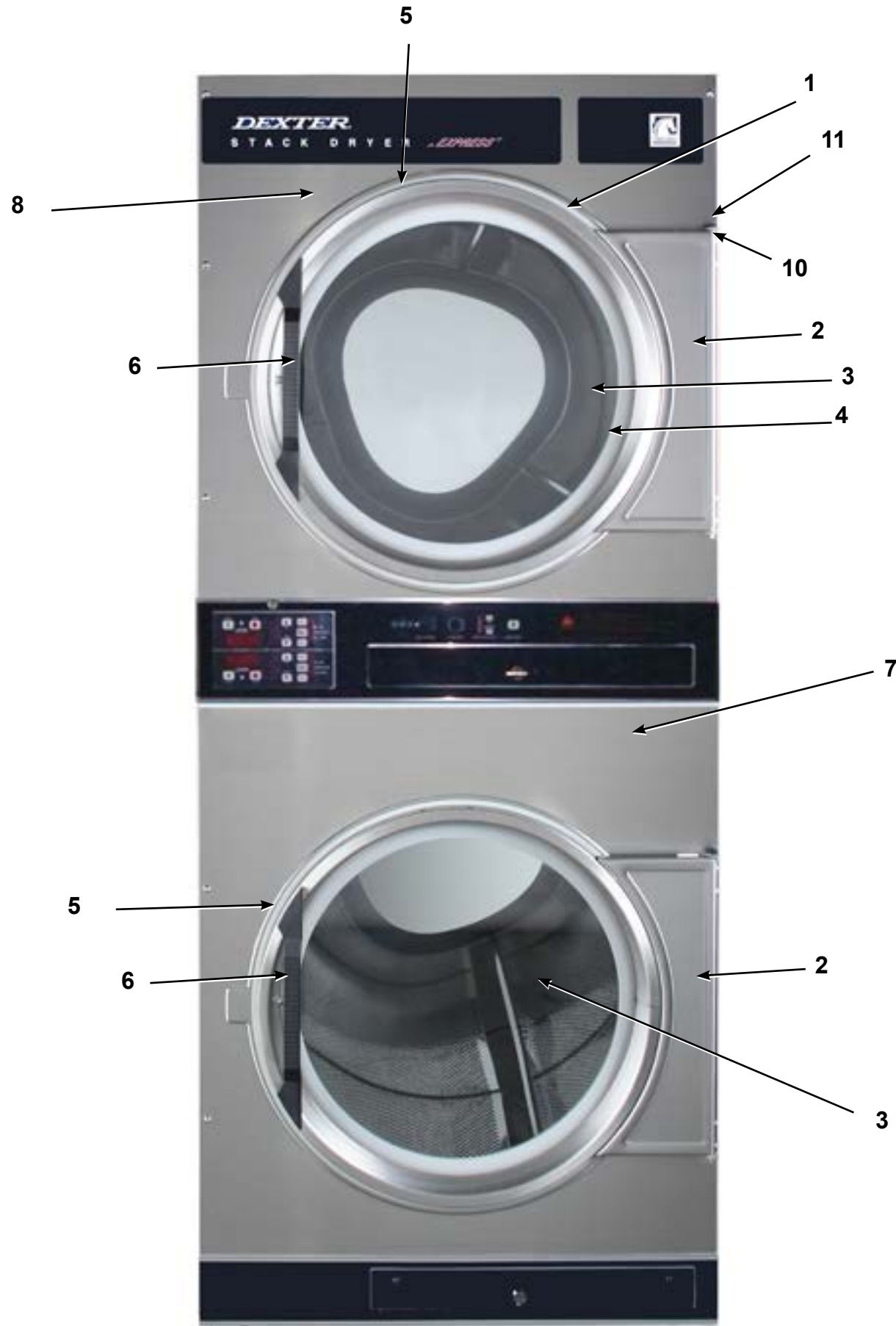

Cabinet Group - 50lb

| Key | Part Number | Description | Quantity |
|-----|--------------|--------------------------------------------------------------|----------|
| * | 9960-285-002 | Door Assy., Loading Complete-Wht | 2 |
| * | 9960-285-001 | Door Assy., Loading Complete-SS | 2 |
| 1 | 9960-284-002 | Door Ring Only, Loading-SS(ring only) | 2 |
| 1 | 9960-320-004 | Door Ring Only, Loading-Black (after serial D1.22290.005) .. | 2 |
| 2 | 9982-353-002 | Plate Assy., Hinge (Wht) No Pin | 2 |
| 2 | 9982-353-001 | Plate Assy., Hinge (SS) No Pin..... | 2 |
| * | 9545-012-015 | Screw, Hinge to Door | 8 |
| * | 8640-413-002 | Nut, Hinge to Door | 8 |
| 3 | 9212-002-004 | Glass, Door | 2 |
| 4 | 9206-164-010 | Gasket, Glass (Gray)..... | 2 |
| 4 | 9206-413-002 | Gasket, Glass (Black)..... | 2 |
| * | 9548-117-000 | Support, Door Glass | 2 |
| 5 | 9206-420-004 | Gasket, Outer Rim (Gray) | 2 |
| 5 | 9206-420-005 | Gasket, Outer Rim (Black) | 2 |
| 6 | 9244-082-001 | Handle, Loading Door | 2 |
| * | 9545-018-017 | Screw, Handle 1/4-20 x 3/8 | 2 |
| * | 9531-033-001 | Stud, Door Catch | 2 |
| * | 8640-413-001 | Nut, Hex | 2 |
| * | 8640-413-003 | Nut, Acorn | 2 |
| * | 9086-015-002 | Catch, Loading Door | 2 |
| * | 8638-190-009 | Pop Rivet for mtg. catch | 4 |
| * | 8641-582-006 | Lockwasher | 4 |
| * | 8640-399-001 | Spring Nut | 6 |
| 7 | 9989-517-011 | Panel Assy., Front- Lower (Wht) | 1 |
| 7 | 9989-517-009 | Panel Assy., Front- Lower (SS) | 1 |
| 8 | 9989-517-015 | Panel Assy., Front- Upper (Wht) | 1 |
| 8 | 9989-517-013 | Panel Assy., Front- Upper (SS) | 1 |
| * | 9277-054-001 | Insulation Front Panel, half moon (top)..... | 2 |
| * | 9277-054-002 | Insulation Front Panel, half moon (bottom)..... | 2 |
| * | 9545-008-014 | Screw, FLHDCR, 10B x 1..... | 14 |
| * | 8641-582-019 | Lockwasher..... | 8 |
| * | 8640-399-001 | Nut, Spring | 12 |
| 10 | 9544-069-002 | Strap, Hinge (Wht) | 2 |
| 10 | 9544-069-004 | Strap, Hinge (SS/Gray) | 2 |
| * | 9545-012-028 | Screw, Hinge to Panel | 8 |
| 11 | 9545-052-001 | Screw, Door to Hinge Strap (Special Black Type) | 2 |
| * | 8641-436-003 | Washer, Fiber | 2 |
| * | 9472-001-013 | Cabinet Touch Up Paint (White)..... | 1 |

Cabinet Group - 50lb (Continued)

| Key | Part Number | Description | Quantity |
|-----|--------------|----------------------------------------------------------------|----------|
| 14 | 9994-049-001 | Escutcheon, Upper | 1 |
| 15 | 9435-025-001 | Trim, Overlay-Upper (Blue) | 1 |
| 15 | 9435-033-001 | Trim, Overlay-Upper (Black) | 1 |
| 16 | 9994-051-001 | Escutcheon, Lower | 1 |
| 17 | 9435-023-001 | Trim, Overlay-Lower (Blue) | 1 |
| 17 | 9435-031-002 | Trim, Overlay-Lower (Black) | 1 |
| * | 9545-020-009 | Screw | 10 |
| 18 | 9412-154-002 | Nameplate Stack Dryer Express (Blue)..... | .1 |
| 18 | 9412-167-001 | Nameplate Stack Dryer Express (Black) | .1 |
| 21 | 9866-007-002 | Lint Drawer Assembly (Blue) | 2 |
| 21 | 9866-007-003 | Lint Drawer Assembly (Black) | 2 |
| 21 | 9435-024-001 | Overlay Trim, Lint Drwr (Blue)..... | 1 |
| 21 | 9435-032-001 | Overlay Trim, Lint Drwr (Black) | 1 |
| * | 9532-143-001 | Felt Seal (back of lint screen assembly) | 2 |
| * | 9805-039-001 | Lint Screen Assembly ONLY (no front) | 2 |
| * | 9555-057-008 | Replaceable Lint Screen Only | 2 |
| 24 | 8650-026-002 | Lock and Key, Lint Drawer Thumb Turn | 2 |
| * | 9505-043-001 | Cam, Lock..... | 2 |
| * | 9545-008-001 | Lint Screen Strap Hold Down Screws 10Bx 1/4 | 32 |
| 22 | 9857-187-001 | Controls Assy, Electronic w/Membrane Switch (Blue) | 1 |
| 22 | 9857-187-003 | Controls Assy, Electronic w/Membrane Switch (Black) | 1 |
| 22 | 9801-096-001 | Membrane Switch Assy (Blue)..... | 1 |
| 22 | 9801-105-001 | Membrane Switch Assy (Black) | 1 |
| * | 9627-885-001 | Harness, Electronic Control | 1 |
| * | 6292-006-007 | Cam, Lock Control | 1 |
| * | 9627-886-001 | Harness, Heat Sensor | 1 |
| * | 9277-041-017 | Insulation Cabinet Cover | 1 |
| 20 | 9501-004-004 | Sensor Temp Control (10K Ohms)..... | 2 |
| * | 9545-045-005 | Screw, Round Head (Mounts sensor; phillips head)..... | 2 |
| * | 9209-037-002 | Grommet, 3/16 ID | 2 |
| * | 8544-006-001 | Leg, Leveling 1/2" | 4 |
| * | 8545-061-002 | Leveling Leg Wrench | 1 |
| * | 9074-320-001 | Cover, Cabinet (Top) | 1 |
| * | 9732-253-001 | DDAD Kit for Dryers without Neutral and using 208-240 volt.... | 1 |
| * | 9732-102-013 | LP Kit for DDAD Dryers 108K BTU | 1 |
| * | 9732-243-001 | Stack Dryer Trunnion Puller | 1 |
| * | 9555-057-010 | Replaceable Lint Screen Fine Mesh Only | 1 |
| * | 9277-054-001 | Insulation-Front Panel-Top Half | 2 |
| * | 9277-054-002 | Insulation-Front Panel-Lower Half | 2 |
| * | 9501-008-002 | Bracket for Heat Sensor Mounting (Under Basket) with Sensor .. | 2 |
| * | 8640-276-002 | Wire Nut Connector Grey..... | 4 |
| * | 9527-007-002 | Standoff Wire Saddle | 8 |
| * | 9544-041-002 | Strap - Bead Tie | 1 |

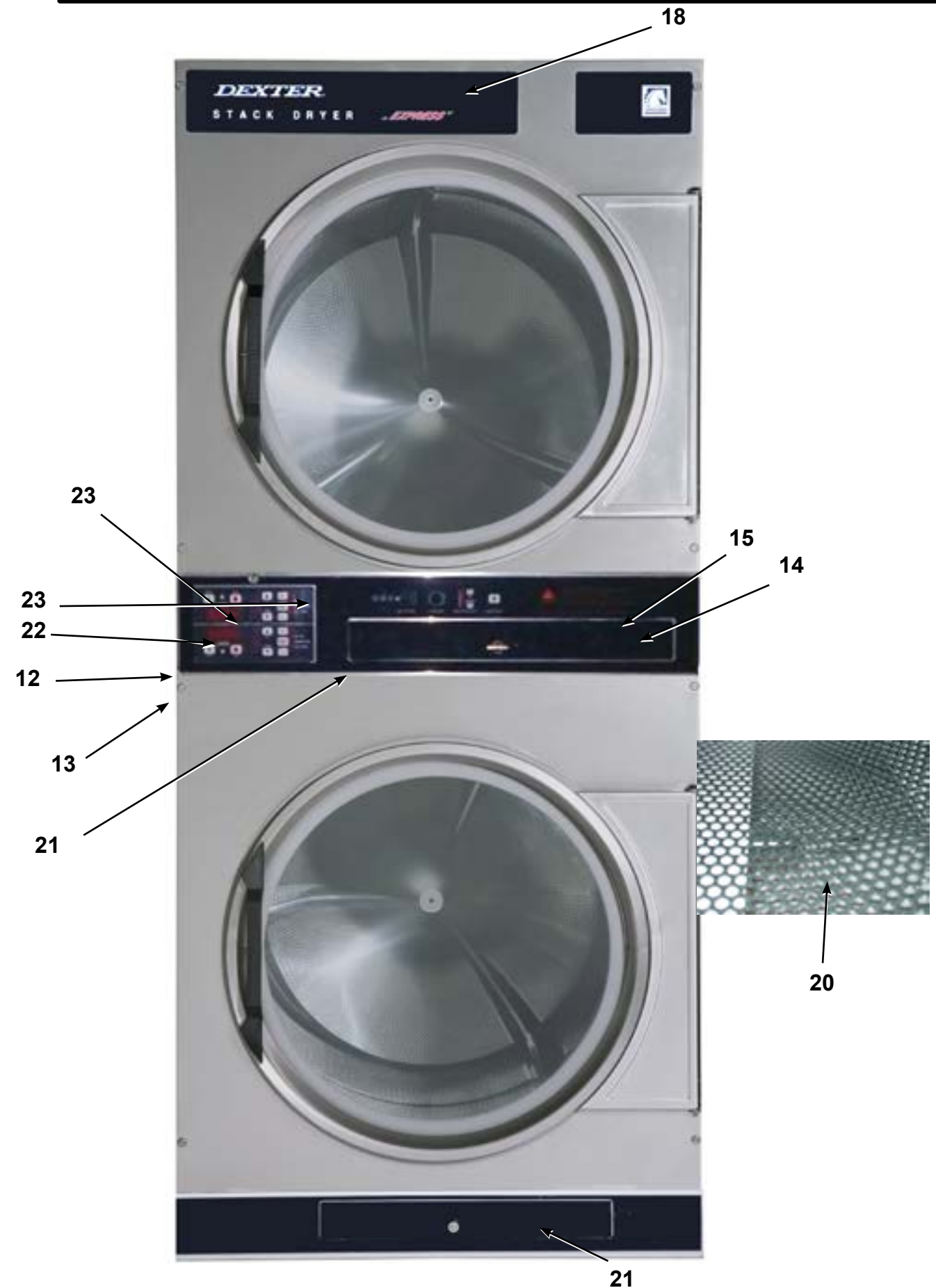

Bearing Housing Group

| Key | Part Number | Description | Quantity |
|-----|--------------|-----------------------------------------------------------------|----------|
| 1 | 9241-189-002 | Housing, Bearing | 2 |
| 2 | 9036-159-003 | Bearing, Ball Rear..... | 2 |
| * | 9538-183-001 | Spacer, Bearing | 2 |
| * | 9036-159-001 | Bearing, Ball Front..... | 2 |
| 5 | 9545-017-017 | Bolt, 1/2 x 3/4..... | 8 |
| 7 | 8640-417-002 | Nut, 1/2 | 8 |
| * | 9803-201-001 | Bearing Housing Complete Ass'y (includes bearings,spacer) | 2 |
| 4 | 9545-017-018 | Screw 1/2 x 1 1/2 | 4 |

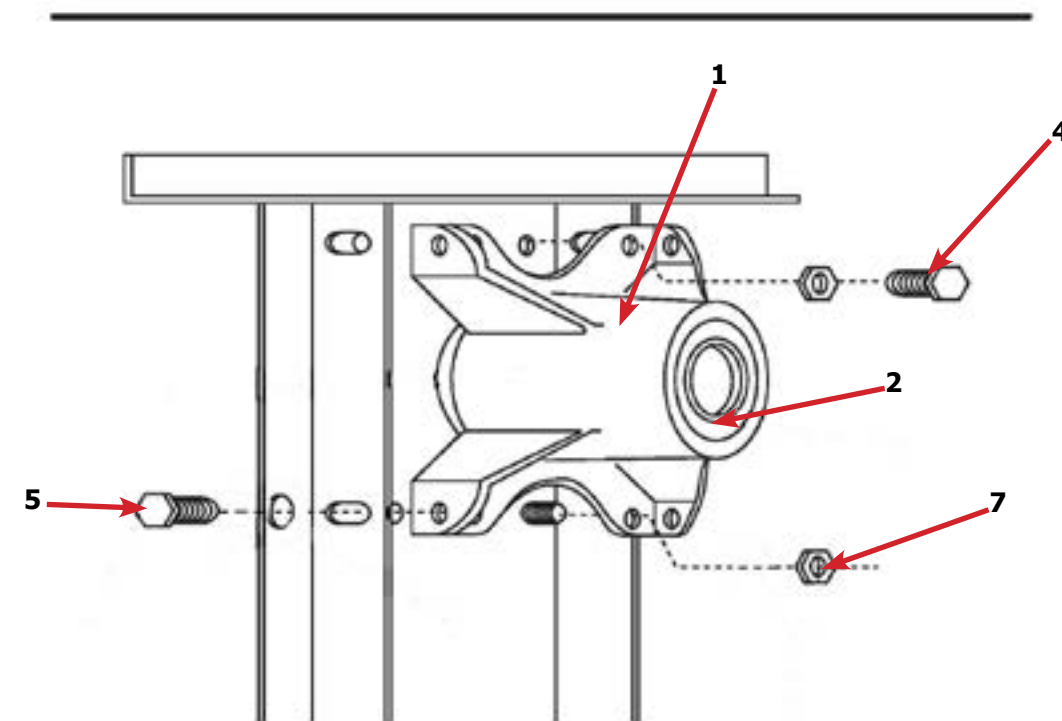

Tumbler Group

| Key | Part Number | Description | Quantity |
|-----|--------------|---------------------------------------------------------|----------|
| 1 | 9848-148-001 | Tumber Assembly Galvanized..... | 2 |
| * | 9848-157-001 | New Tumbler, Taller Baffles (Anti-Roping)..... | 2 |
| * | 9848-148-002 | Tumbler Assembly Stainless Steel..... | 2 |
| * | 9848-149-001 | Tumbler Assembly Galvanized w/spider..... | 2 |
| * | 9848-158-001 | New Tumbler, Taller Baffles (Anti-Roping) w/spider..... | 2 |
| * | 9848-149-002 | Tumbler Assembly Stainless w/spider..... | 2 |
| 2 | 9568-013-001 | Spider Assembly | 2 |
| 3 | 9497-226-002 | Rod, Tumbler | 6 |
| 5 | 8640-417-005 | Nut, 1/2 - 13 | .6 |
| 4 | 8641-590-002 | Washer, Special | 6 |
| 6 | 9552-013-000 | Shim | .AR |

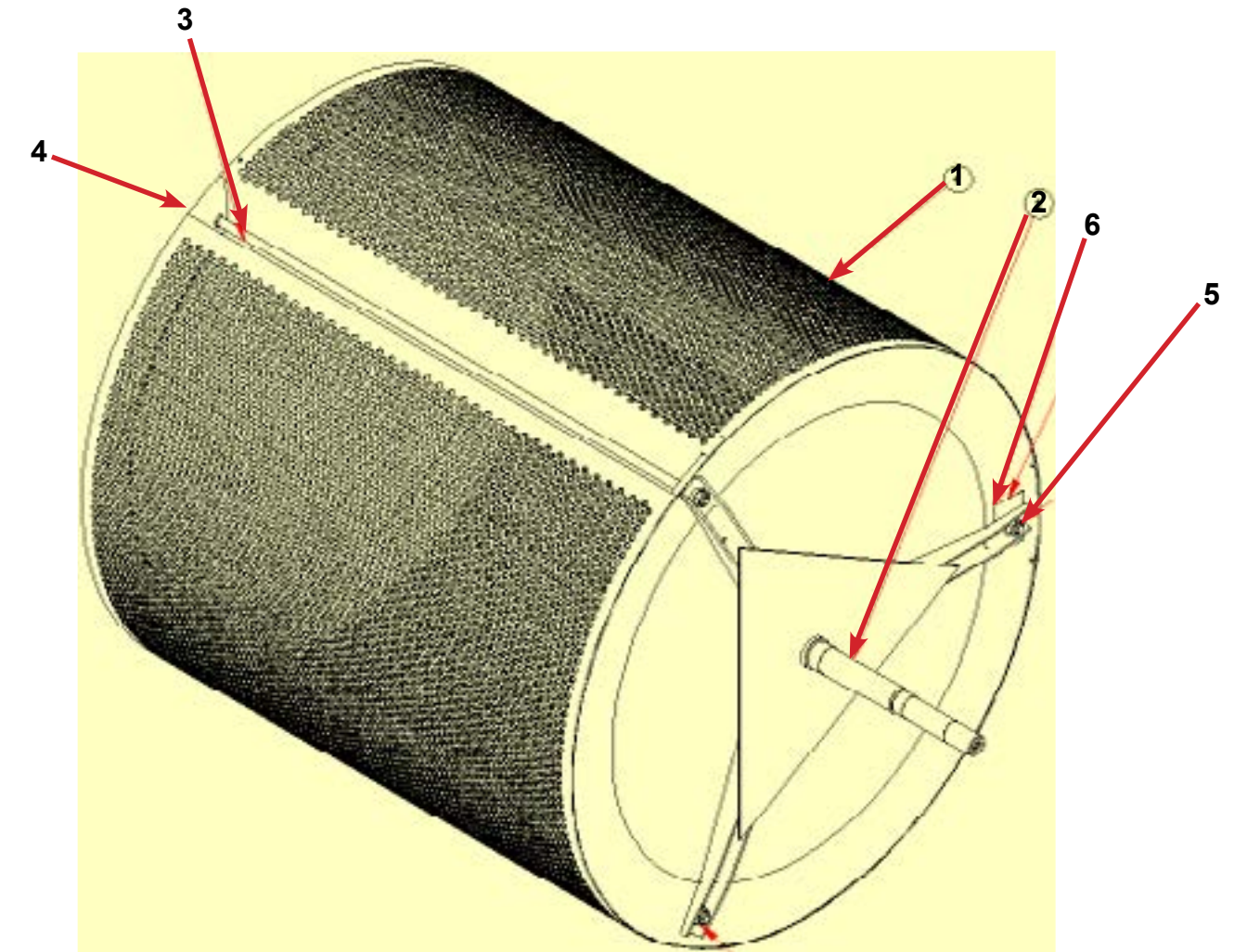

Burner Housing Group - 50lb

| Key | Part Number | Description | Quantity |
|--------|--------------|------------------------------------------------------------|----------|
| * | 9803-230-001 | Housing Assembly, Burner | 2 |
| 1a | 9452-730-001 | Service Burner Plate Front..... | 2 |
| 1 | 9452-850-001 | Service Plate baffle Recirculation Chamber Clean Out | 2 |
| * | 9545-008-006 | Screws | 8 |
| 2 | 9545-008-001 | Screw | 16 |
| 18 | 9003-220-001 | Angle, Burner Support | 2 |
| * | 9545-008-006 | Screw | 4 |
| 17 | 9048-020-002 | Burner, Main | 4 |
| * | 9545-008-006 | Screw 10AB x 3/8" | 4 |
| * | 9454-992-001 | Panel, Back Burner Housing..... | 2 |
| 4 | 9545-008-001 | Screw 10B x1/4" | 8 |
| 5 | 9875-002-003 | Electrode Assy, Ignition | 2 |
| 19 | 9545-045-001 | Screw, Electrode Mtg 8B x 1/4"..... | 4 |
| 7 | 9379-186-001 | Valve, Gas Shut Off (Optional) | 1 |
| 8 | 9587-192-001 | Control Assy, Gas | 2 |
| 9 | 9381-012-001 | Manifold, Assembly 2 Part 1 Piece..... | 2 |
| * | 9425-069-021 | Orifice, Burner-Natural #29..... | 4 |
| * | 9425-069-022 | Orifice, Burner-LP #46..... | 4 |
| 10, 14 | 9029-175-001 | Bracket, Manifold | 4 |
| 22 | 8615-104-038 | Pipe Plug in end of Burner Manifold | 2 |
| * | 9545-008-006 | Screw | 4 |
| 12 | 9576-203-002 | Thermostat, Hi-Limit | 2 |
| * | 9538-142-001 | Spacer, Hi-Limit | 4 |
| * | 9545-045-007 | Screw 8B x 3/4" | 4 |
| 13 | 9074-329-001 | Cover, Hi-Limit Stat Ignitor | 2 |
| * | 9545-008-006 | Screw | 6 |
| * | 9576-207-008 | Thermostat, Safety Shutoff | 2 |
| * | 9545-008-006 | Screw | 4 |
| 15 | 9825-062-001 | Cover, Safety Stat | 2 |
| * | 9545-008-006 | Screw | 4 |
| 16 | 9857-116-003 | Control, Ignition Fenwall (3 trybox) | 2 |
| * | 9732-102-045 | Kit, LP Conversion 50 Stack (White Rodgers) | 2 |
| * | 9838-018-003 | Welded One Piece Gas Pipe Assembly | 1 |
| * | 9732-360-003 | Gas Pipe Assembly Replacement Kit..... | 1 |
| * | 9838-023-003 | Gas Pipe Assembly (After Serial)..... | 1 |
| * | 8615-120-001 | Fitting - 1/2 NPT Union Adapter | 1 |

Burner Housing Group Photos - 50lb

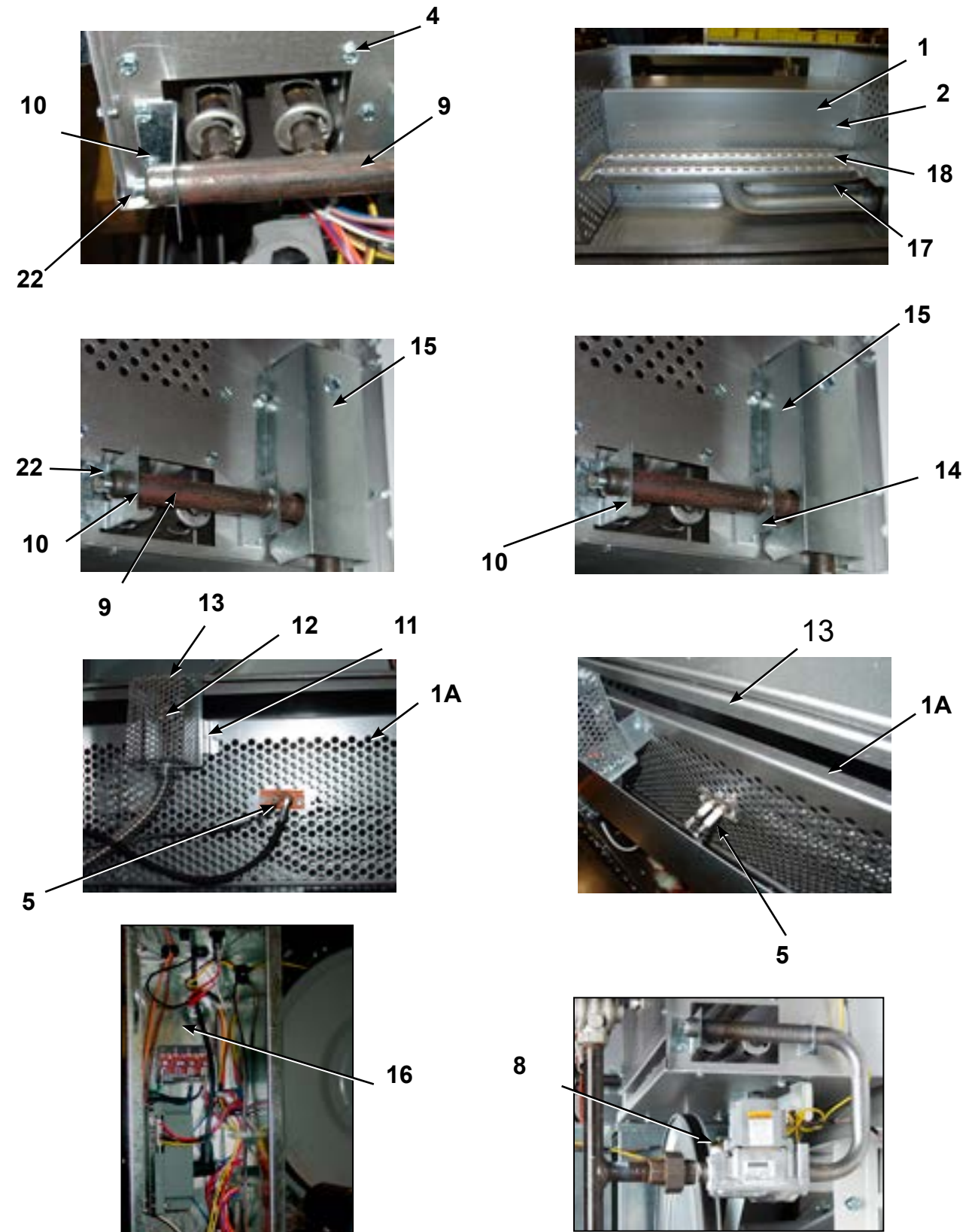

Rear View

| Key | Part Number | Description | Quantity |
|-----|--------------|---------------------------------------------------------|----------|
| * | 9627-861-001 | Wire Harness, Overtemperature Switch Upper | 1 |
| * | 9801-098-001 | Switch Assy, Air Flow | 2 |
| 1 | 9539-461-009 | Switch, Air Flow | 2 |
| 2 | 9029-200-001 | Bracket, Switch-Air Flow | 2 |
| * | 8640-401-001 | Nut, Special Twin #4-40 | 2 |
| * | 9550-169-003 | Shield, Switch | 2 |
| 3 | 9008-007-001 | Actuator, Switch..... | 2 |
| 4 | 9451-169-002 | Pin, Cotter..... | 2 |
| 5 | 9545-020-001 | Screw, 4-40x 5/8 | 4 |
| 7 | 9376-322-001 | Motor, Drive | 2 |
| * | 5191-108-002 | Run Capacitor..... | 2 |
| * | 5191-109-002 | Start Capacitor..... | 2 |
| 27 | 9453-169-013 | Motor-Pulley, Driver..... | 2 |
| * | 9452-770-001 | Plate, Motor Mounting | 2 |
| 9 | 9962-018-002 | Plate, Impeller Mounting..... | 2 |
| * | 9538-163-006 | Spacer, Motor Mounting | 8 |
| * | 9545-029-008 | Screws, Hex Cap..... | 8 |
| * | 8641-582-003 | Lock Washers..... | 8 |
| * | 9545-018-019 | Screw HXHD 1/4-20 x 2 1/2 | 8 |
| * | 8641-581-017 | Washer-Flat, 1/4 x 7/8 | 32 |
| * | 9538-166-006 | Spacer, Metal..... | 8 |
| 12 | 9991-053-001 | Support Assy, Intermediate pulley | 2 |
| 12 | 9545-029-010 | Bolt, Rd Hd 3/8-16 x 1 1/4 | 6 |
| 12 | 8640-415-004 | Nut Flange Wizlock 3/8 - 16 | 6 |
| 12 | 8641-581-035 | Washer, Flat | 6 |
| 13 | 9545-029-003 | Bolt, 3/8 - 16 x 1 1/2..... | 2 |
| 14 | 9861-022-001 | Arm Assy-Tension, Complete..... | 2 |
| * | 9487-200-003 | Ring-Retaining | 6 |
| 16 | 9908-048-003 | Pulley Assy, Intermediate w/Bronze Flange Bearing | 2 |
| * | 9036-145-002 | Bearing - Bronze Flange | 4 |
| 17 | 9908-047-002 | Pulley Driven, Tumbler..... | 2 |
| * | 9487-234-005 | Tolerance Ring..... | 2 |
| 34 | 8641-581-026 | Washer, Flat 1/2" for Tumbler Pulley..... | 2 |
| 35 | 9545-017-009 | Bolt, 1/2" - 13 x 1 1/4 | 2 |
| 36 | 8641-582-016 | Washer, Star 1/2" for Tumbler Pulley | 2 |
| * | 9538-184-001 | Spacer, Shaft..... | 2 |
| 19 | 9040-076-009 | Belt, Drive Motor and intermediate..... | 2 |
| 20 | 9040-073-011 | Belt, Driven-intermediate to..... | 2 |
| 21 | 9534-151-000 | Spring, Tension..... | 2 |
| 22 | 9099-012-005 | Chain Tension..... | 2 |
| 23 | 9248-022-002 | Hook, Tension | 2 |
| * | 9451-146-001 | Pin, Damper Hinge..... | 2 |
| * | 8520-141-000 | Nut, Spring..... | 4 |
| * | 9825-334-001 | Cover, Duct-Upper | 1 |
| 25 | 9973-032-001 | Heat Recirculation Assembly Duct | 2 |
| * | 9545-028-013 | Set Screw..... | 2 |
| 30 | 9278-043-001 | Impeller | 2 |
| * | 9125-007-001 | Damper, Exhaust Duct - Upper | 1 |
| * | 9125-007-002 | Damper, Exhaust Duct - Lower | 1 |
| * | 8520-141-000 | Nut, Spring..... | 4 |
| * | 9545-008-026 | Screw #10B x 1/2 | 14 |
| * | 9074-335-001 | Cover, Duct - Lower | 1 |
| * | 9545-008-024 | Screw #10AB x 3/8 | 58 |
| * | 9029-173-001 | Bracket for Wire Harness Under Burner Housing | 2 |

Rear View Photos - 50lb

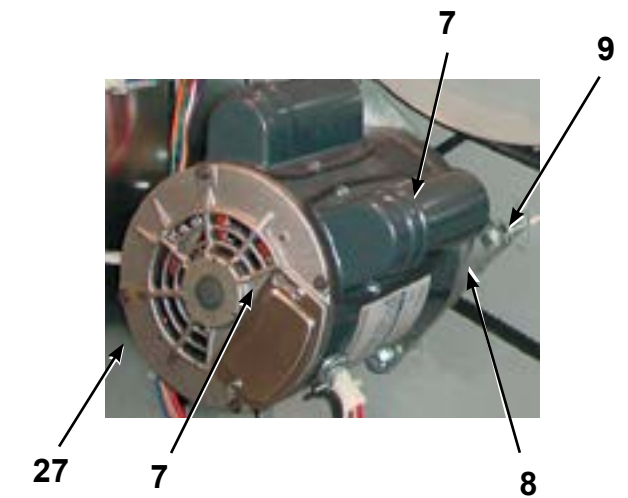
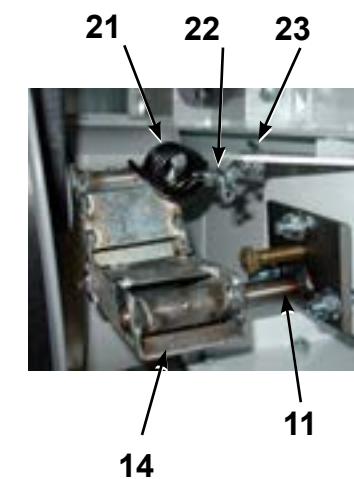
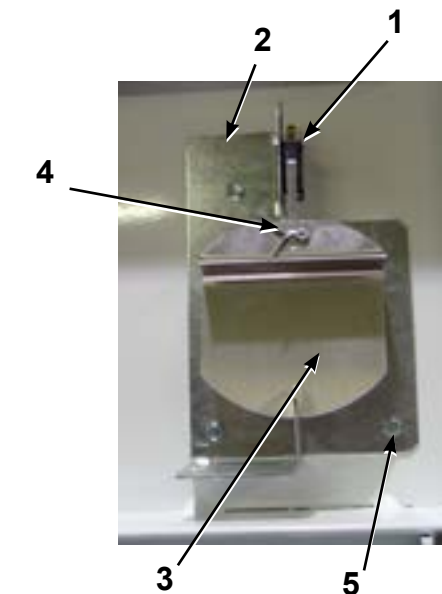
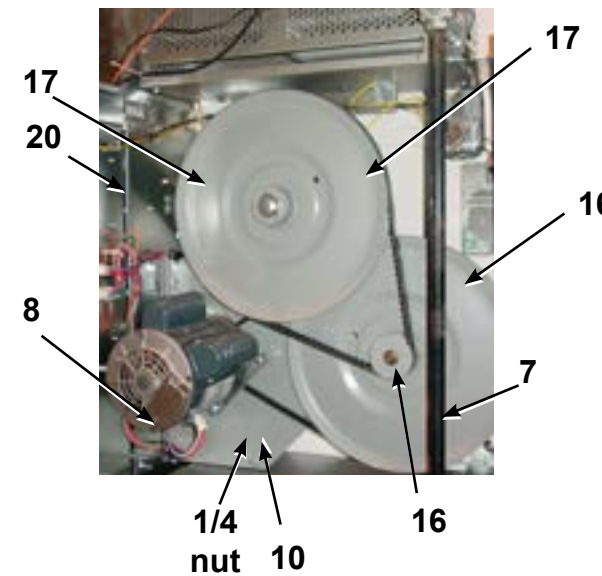
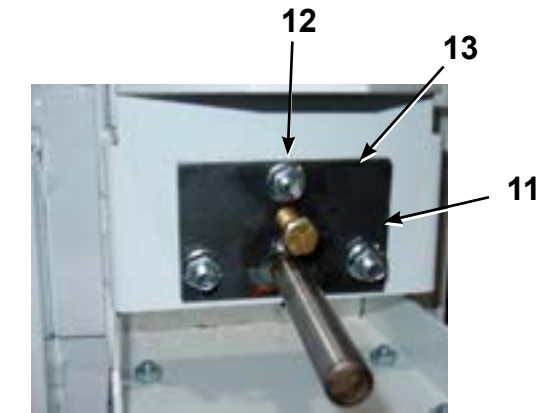
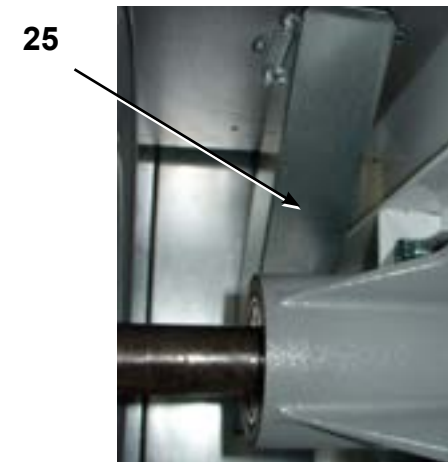

Rear Panel & Cover Group - 50 lbs

| Key | Part Number | Description | Quantity |
|-----|--------------|----------------------------------------------|----------|
| 1 | 9208-090-001 | Rear Guard Side Panel 1..... | 2 |
| 4 | 9545-008-024 | Screws 10 AB x 3/8..... | 30 |
| * | 9208-089-001 | Rear Guard Top, Lower..... | 1 |
| 7 | 9545-008-024 | Screws 10 AB x 3/8..... | 6 |
| 8 | 9208-089-001 | Rear Guard Back Panel..... | 2 |
| * | 9545-008-024 | Screws, Guard..... | * |
| 10 | 8502-600-001 | Label Warning & Notice..... | 1 |
| 11 | 8502-645-001 | Label - Instructions..... | 1 |
| 12 | 9109-113-001 | Transition Assembly Outlet..... | 1 |
| 13 | 9074-320-001 | Top Cover Dryer Panel..... | 1 |
| 14 | 9550-188-001 | Top Burner Housing Heat Shield..... | 1 |
| * | 9973-034-001 | 8" Slide Open Clean Out Duct (Optional)..... | 1 |

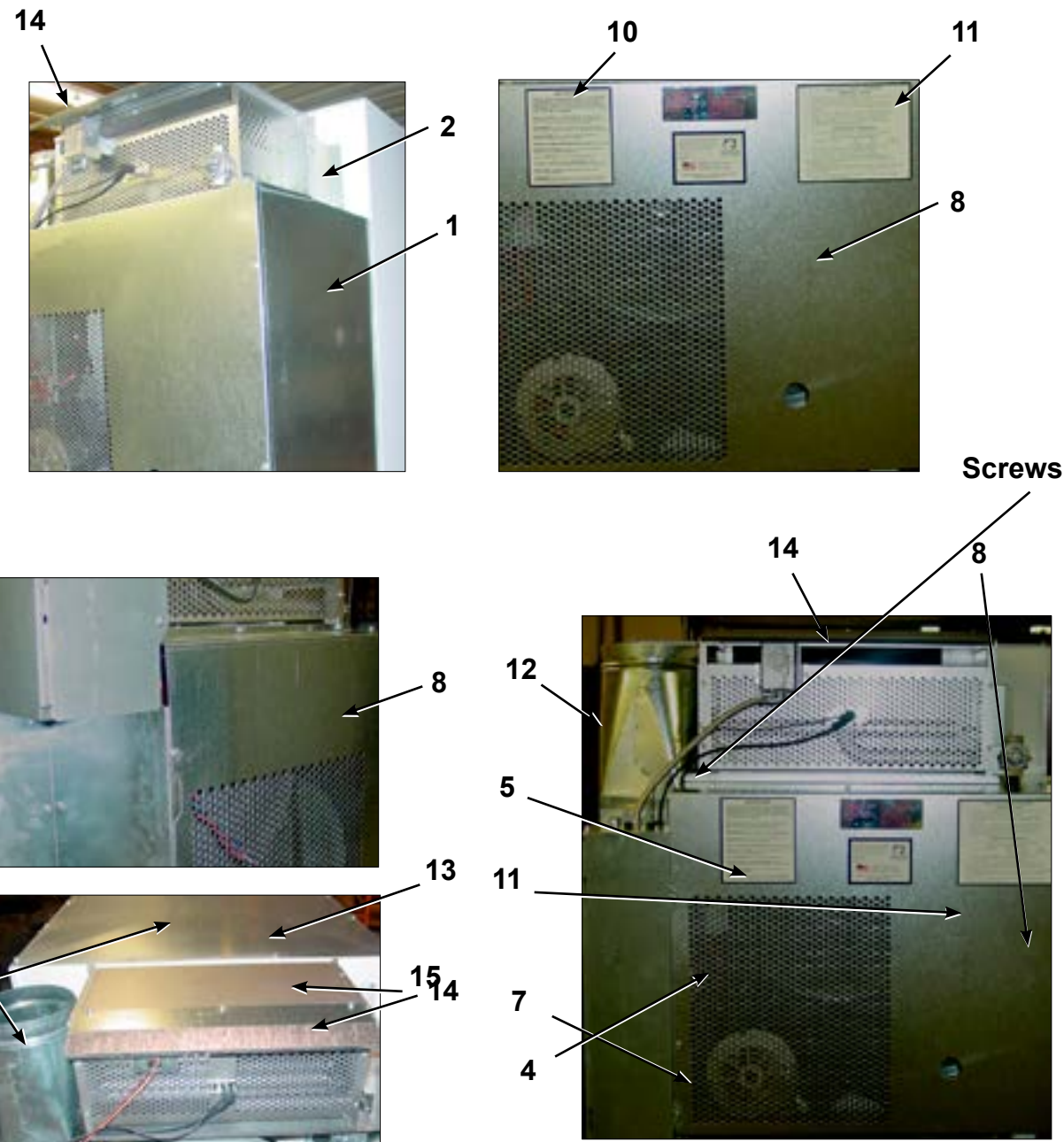

Screws

OPL Control Board

| Key | Part Number | Description | Quantity |
|-----|--------------|-------------------------------------------|----------|
| 1 | 9801-096-001 | Control Assembly (Blue)..... | 1 |
| 1 | 9801-105-001 | Control Assembly (Black)..... | 1 |
| 2 | 9471-017-001 | PCB Control Board..... | 1 |
| 3 | 9471-018-001 | PCB Display Board..... | 1 |
| 4 | 9500-007-001 | Cable, Upper Control Long..... | 1 |
| 5 | 9500-007-002 | Cable, Lower Control Long..... | 1 |
| 6 | 9801-096-001 | Membrane Switch Assembly (Blue)..... | 1 |
| 6 | 9412-167-001 | Membrane Switch Assembly (Black)..... | 1 |
| 7 | 8636-024-001 | Fuse, 600ma / 250v..... | 2 |
| * | 9627-885-001 | Harness Main Control OPL Stack Dryer..... | 1 |

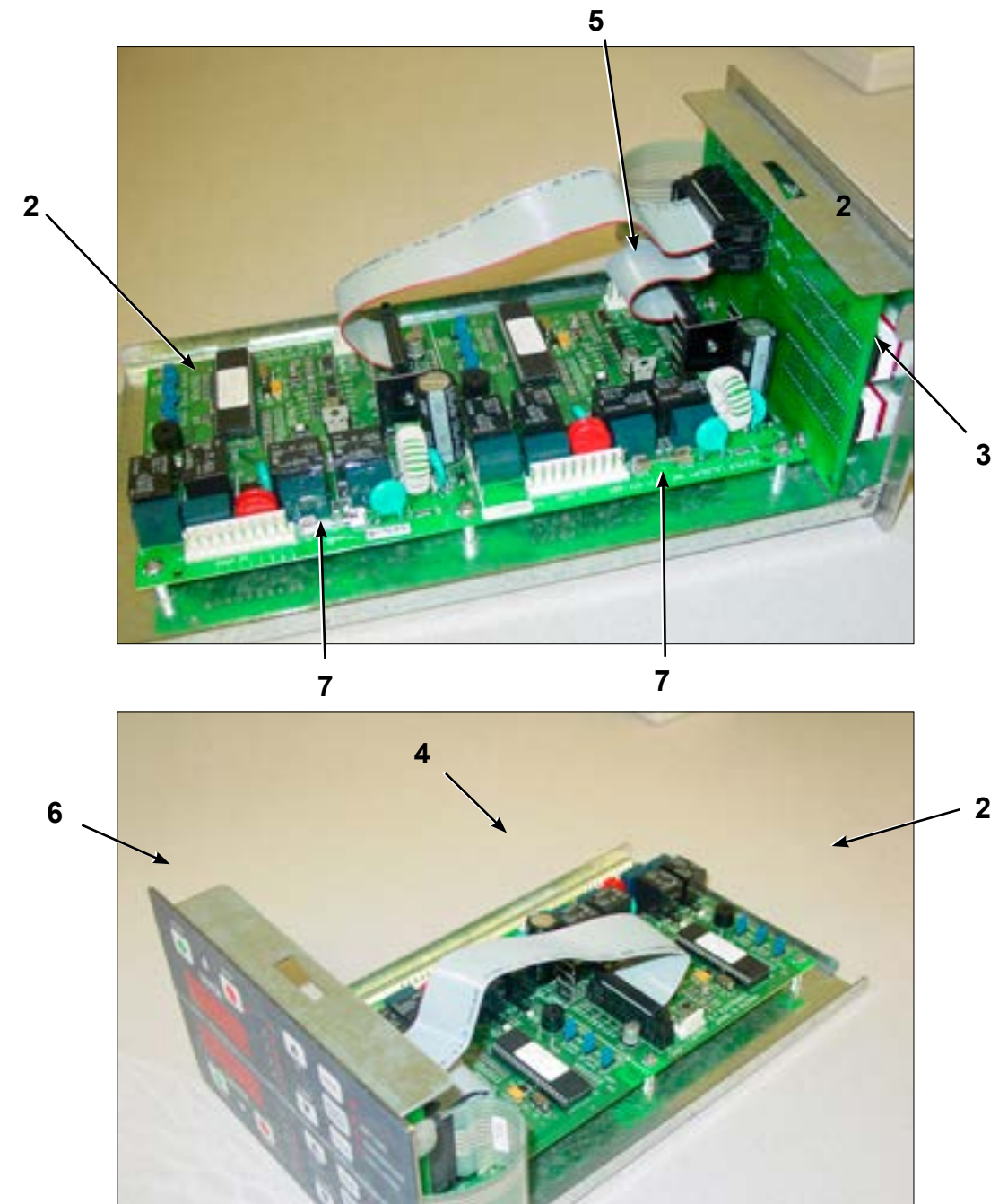

Control Assembly Group

| Key | Part Number | Description | Quantity |
|-----|--------------|---------------------------------------------------------|----------|
| * | 9857-189-009 | Control Assembly Complete (all below included) | 1 |
| * | 9074-317-001 | Control Box Cover | 1 |
| 1 | 8653-068-003 | Connector Conduit 3/8" STR | 1 |
| 2 | 9558-029-003 | Strip Terminal Marker (Behind Input Power) to above #3 | 1 |
| 3 | 9897-035-001 | Terminal Block Assembly Main Power Inlet | 1 |
| * | 9545-008-024 | Screws 10AB x 3/8" | 4 |
| * | 9627-859-003 | Wire Harness - Power Main | 1 |
| 4 | 8220-001-478 | Wire Assembly Green 7" | 1 |
| 5 | 9545-008-027 | Screw # 10-32 x 12 Green | 1 |
| * | 8641-582-006 | Lockwasher Ext Tooth #10 | 1 |
| 6 | 9897-026-002 | Terminal Block Main Power Middle | 1 |
| 7 | 9897-026-001 | Terminal Block | 2 |
| * | 9545-045-012 | Screw #8 ABx1 2 for terminal block | 6 |
| 8 | 8711-013-001 | Transformer Control | 1 |
| * | 9545-008-024 | Screws 10AB x 3/8" | 4 |
| 9 | 9857-182-001 | Ignition Control | 2 |
| * | 9545-008-018 | Screws 10AB x 3/4" | 4 |
| 10 | 9631-403-009 | Wire Assembly High Voltage Upper | 1 |
| 11 | 9627-867-005 | Wire Harness Ignition Control Upper | 1 |
| 12 | 9631-403-008 | Wire Assembly High Voltage Lower | 1 |
| 13 | 9627-867-006 | Wire Harness Ignition Control Lower | 1 |
| * | 9053-067-002 | Bushing Wire 7/8" | 4 |
| 14 | 9200-001-002 | Fuseholder Assembly | 3 |
| * | 8636-018-001 | Fuse 1.5 Amp | 2 |
| * | 8636-018-004 | Fuse 2.5 Amp | 1 |
| 15 | 5192-299-001 | Relay Power | 2 |
| * | 9545-045-012 | Screws Power #8 AB x 1/2" | 4 |
| * | 8220-062-036 | Wire Assembly Red/Black 14" | 1 |
| * | 8220-062-037 | Wire Assembly Red/White 14" | 1 |
| 16 | 9627-864-006 | Wire Harness Motor Extension | 2 |
| 17 | 9527-007-001 | Stand Off - Wire Saddle / Arrowhead | 5 |
| 18 | 9627-863-001 | Wire Harness Main Extension Access Under Burner Housing | 4 |

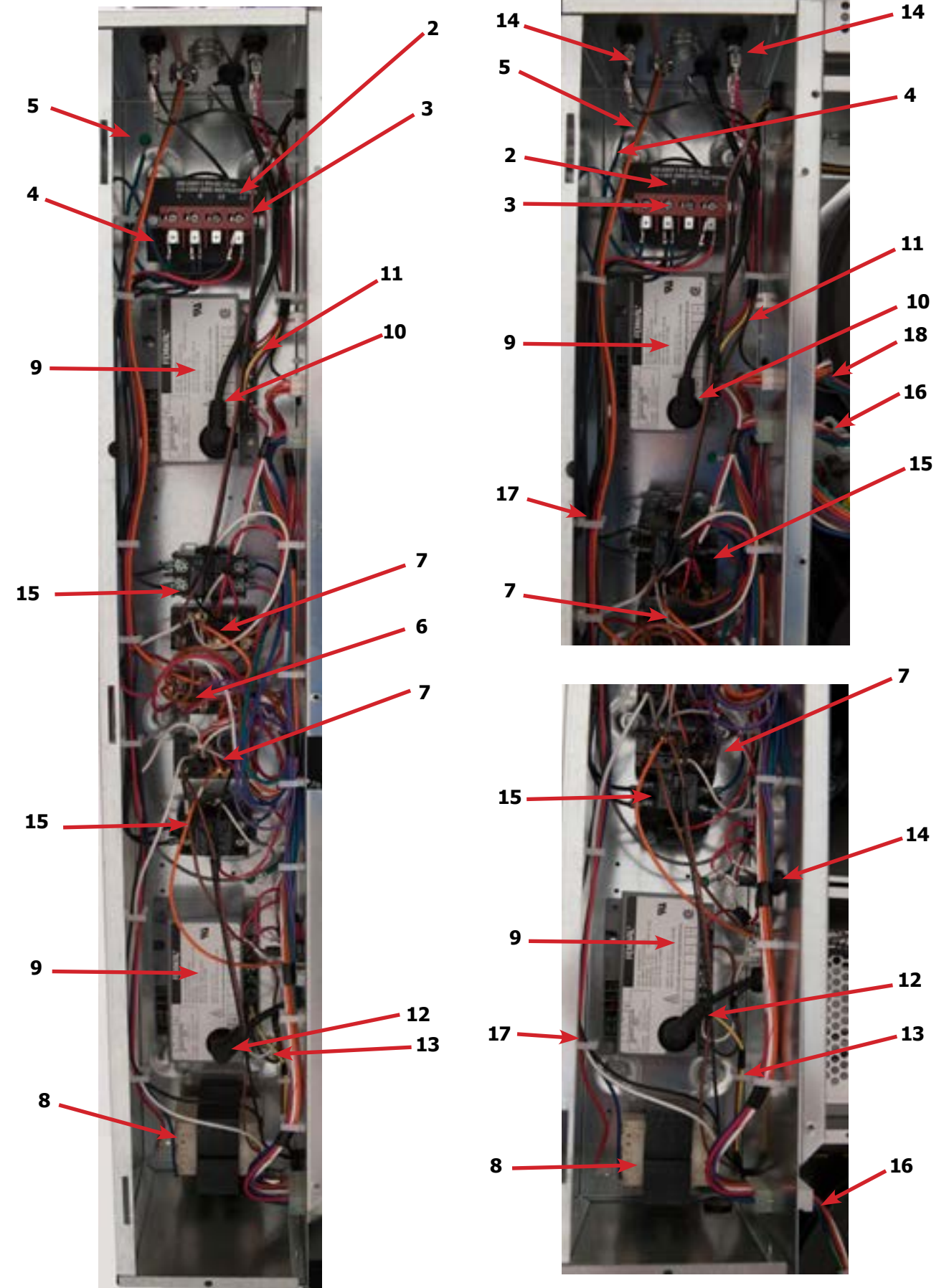

Control Protection Fuse 2.5 Amp **14** **1** Ignition Upper Pocket Protection Fuse 1.5 Amp **14**



Not Shown:
24VAC Ignition Lower
Pocket Protection
Fuse

Section 8:

Electric Heated

60Hz

Electric Heated Parts DN30X2EC-71/-74EB

| Key | Part Number | Description | Quantity |
|-----|--------------|---------------------------------------|----------|
| * | 8220-001-499 | Wire-BLK, 26" | 2 |
| * | 8220-057-016 | Wire-BLK, 8", 8 AWG..... | 6 |
| * | 8220-057-021 | Wire-WHT, 5 1/2", 18 AWG..... | 2 |
| * | 8220-057-023 | Wire-BLK, 9 1/2", 10 AWG..... | 12 |
| * | 8220-057-031 | Wire-BLK, 36", 12 AWG..... | 1 |
| * | 8220-057-032 | Wire-RED, 36", 12 AWG..... | 1 |
| * | 8220-061-011 | Wire-BLK, 17", 10 AWG | 12 |
| * | 8220-063-020 | Wire-WHT/BLK, 65" 18 AWG..... | 1 |
| * | 8220-078-014 | Wire-BLK, 22" 18 AWG..... | 2 |
| * | 8220-095-023 | Wire-BRN, 54" 18 AWG..... | 2 |
| * | 8220-103-002 | Wire-Red, 19" 18AWG..... | 2 |
| * | 9636-155-001 | Wrapper-Housing, Heater..... | 2 |
| * | 9545-008-001 | Screw 10B x 1/4..... | 6 |
| * | 9551-032-001 | Side-Housing, Heater, Right Hand..... | 2 |
| * | 9551-033-001 | Side-Housing, Heater, Left Hand..... | 2 |
| * | 9551-040-001 | Side Control Heater..... | 4 |
| * | 9114-044-001 | Defl ector-Bottom Housing..... | 2 |
| * | 9545-008-024 | Screw-10AB x 3/8..... | 6 |
| * | 9058-026-001 | Bottom-Housing, Heater..... | 2 |
| * | 9545-008-024 | Screw-10AB x 3/8..... | 22 |
| * | 9114-045-001 | Defl ector-Wraper, Housing..... | 2 |
| * | 9545-008-024 | Screw-10AB x 3/8..... | 8 |
| * | 9114-046-001 | Defl ector-Baffl e..... | 12 |
| * | 9049-078-001 | Baffl e-Housing, Heater..... | 2 |
| * | 9636-191-001 | Wrapper-Control, Heater..... | 2 |
| * | 9074-293-001 | Cover-Plate, Heater..... | 2 |
| * | 9551-040-001 | Side-Control Heater..... | 4 |
| * | 9545-008-024 | Screw-10AB x 3/8..... | 16 |
| * | 9029-194-001 | Bracket-Control, Heater..... | 4 |
| * | 9074-333-001 | Cover-Control, Heater..... | 2 |
| * | 9545-018-014 | Screw-1/4-20 x 3/4..... | 8 |
| * | 9277-041-014 | Insulation..... | 2 |
| * | 9029-181-001 | Bracket-Back, Panel..... | 1 |
| * | 9074-337-001 | Cover-Terminal, Heater..... | 2 |
| * | 9576-207-006 | Thermostat-Overtmp, Manual reset..... | 2 |
| * | 9538-166-005 | Spacer Over Temp Thermostat..... | 4 |
| * | 9982-364-001 | Plate Assembly-Overtmp switch..... | 2 |
| * | 9627-861-002 | Harness-Over Temp Switch..... | 2 |
| * | 9348-066-001 | Lever-Overtmp Switch..... | 2 |
| * | 9452-769-001 | Plate-Over Temp Switch..... | 2 |
| * | 9497-229-001 | Rod-Over Temp Switch..... | 2 |
| * | 9488-011-002 | Rail-Din, 35 x 15mm..... | 2 |

DN30X2EC-71/-74EB 240/60/3 24KW

| Key | Part Number | Description | Quantity |
|-----|--------------|-------------------------------------|----------|
| * | 5192-285-004 | Relay..... | 2 |
| * | 5192-296-001 | Relay, Heating Element..... | 2 |
| * | 9377-003-001 | Varister-Coil Suppressor..... | 2 |
| * | 5198-213-002 | Circuit Breaker-3 Pole..... | 4 |
| * | 8652-134-002 | Terminal-Lug, Solderless..... | 4 |
| * | 9870-093-004 | Heater Element, 12KW 208V..... | 6 |
| * | 9295-004-002 | Jumper-Formed..... | 4 |
| * | 9295-005-002 | Jumper-Straight..... | 8 |
| * | 9897-037-001 | Block-Power, 3 Pole..... | 2 |
| * | 9897-038-001 | Block-Power, 1 Pole..... | 2 |
| * | 9506-466-001 | Wiring-Schematic..... | 1 |
| * | 9506-467-001 | Wiring-Diagram..... | 1 |
| * | 9506-468-001 | Wiring-Diagram/Schematic..... | 1 |
| * | 8514-202-001 | Booklet-Owners, DDAD30HC_-16FC..... | 1 |

30Lb Schematic Diagram -71

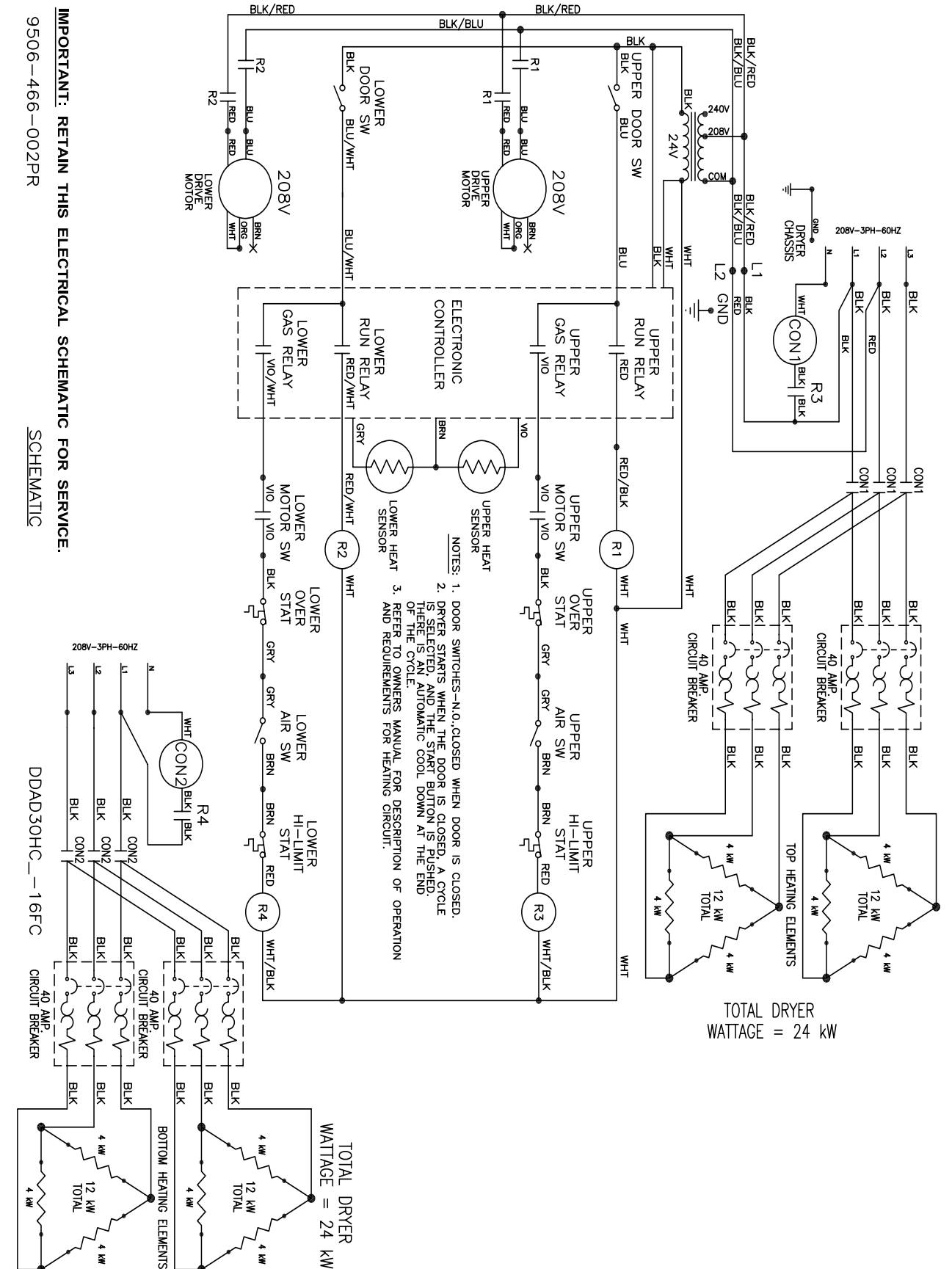

30Lb Wiring Diagram -71

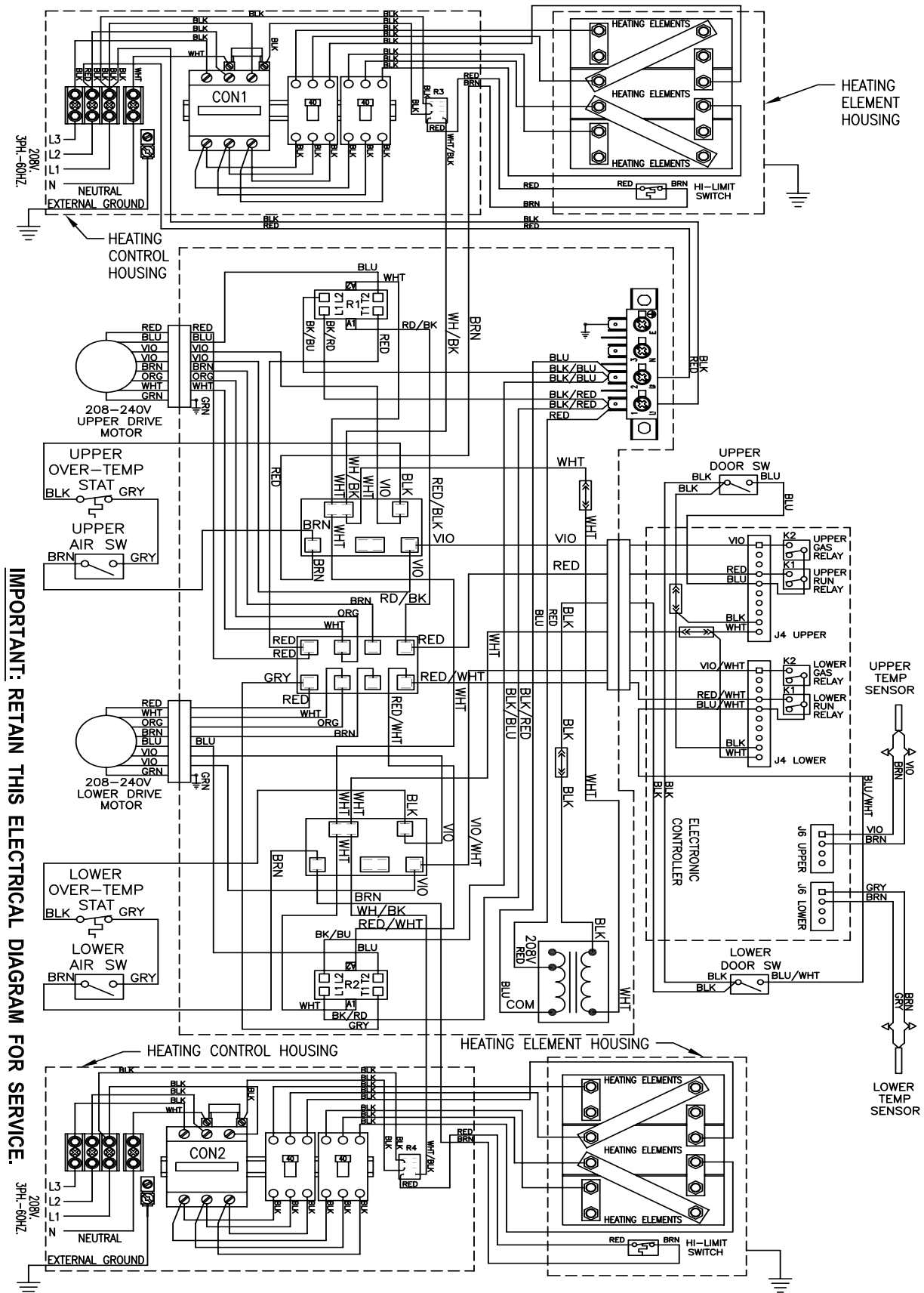

IMPORTANT: RETAIN THIS ELECTRICAL DIAGRAM FOR SERVICE.
 9506-467-002A WIRING DIAGRAM DDAD30HC-16FC

30Lb Schematic Diagram -74

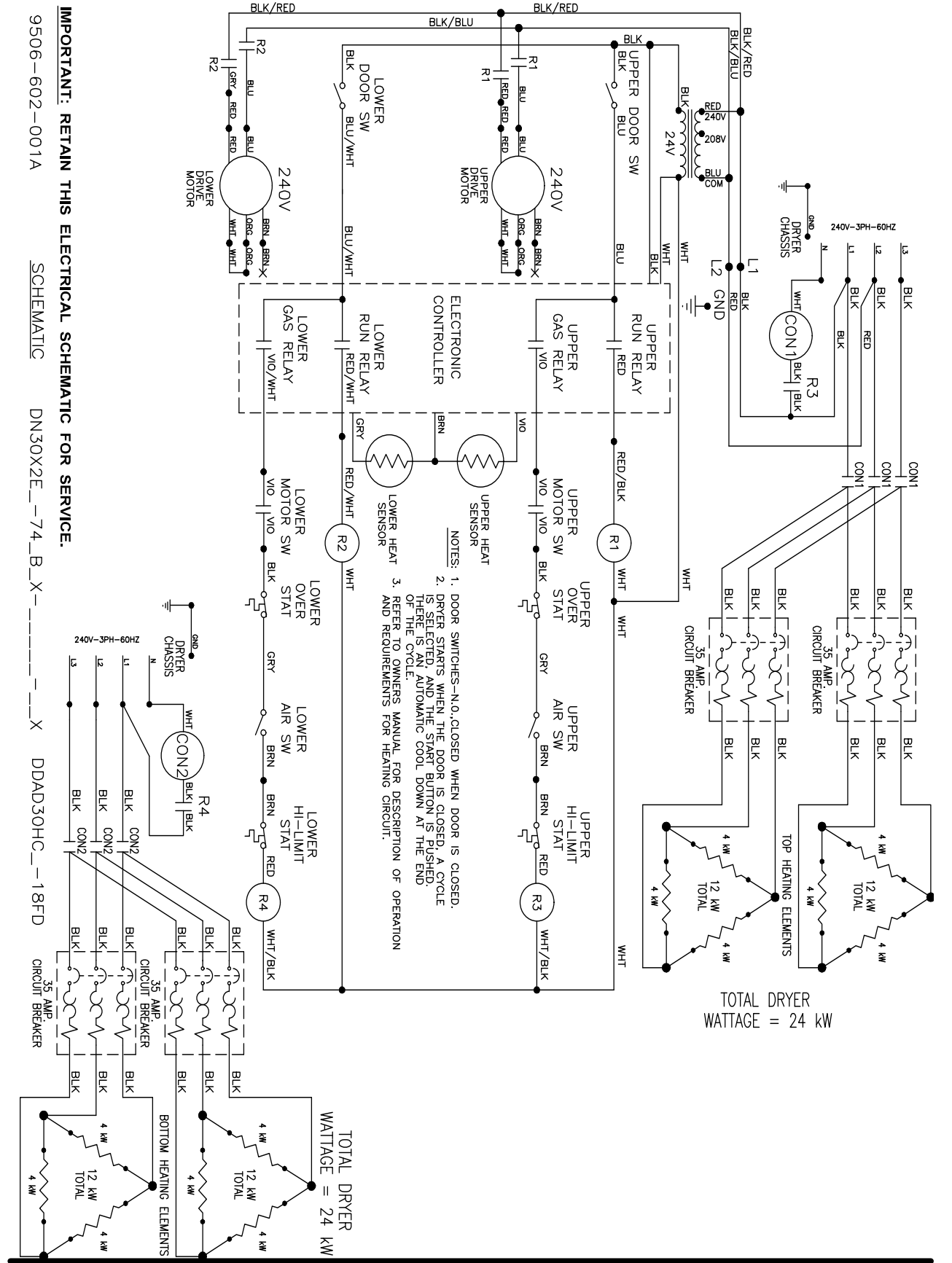

IMPORTANT: RETAIN THIS ELECTRICAL SCHEMATIC FOR SERVICE.
 9506-602-001A SCHEMATIC DN30X2E-74_B_X- X DDAD30HC-18FD

- NOTES:
1. DOOR SWITCHES-N.O.CLOSED WHEN DOOR IS CLOSED.
 2. DRYER STARTS WHEN THE DOOR IS CLOSED, A CYCLE IS SELECTED, AND THE START BUTTON IS PUSHED. HERE IS AN AUTOMATIC COOL DOWN AT THE END OF THE CYCLE.
 3. REFER TO OWNERS MANUAL FOR DESCRIPTION OF OPERATION AND REQUIREMENTS FOR HEATING CIRCUIT.

TOTAL DRYER WATTAGE = 24 kW

TOTAL DRYER WATTAGE = 24 kW

30Lb Wiring Diagram -74

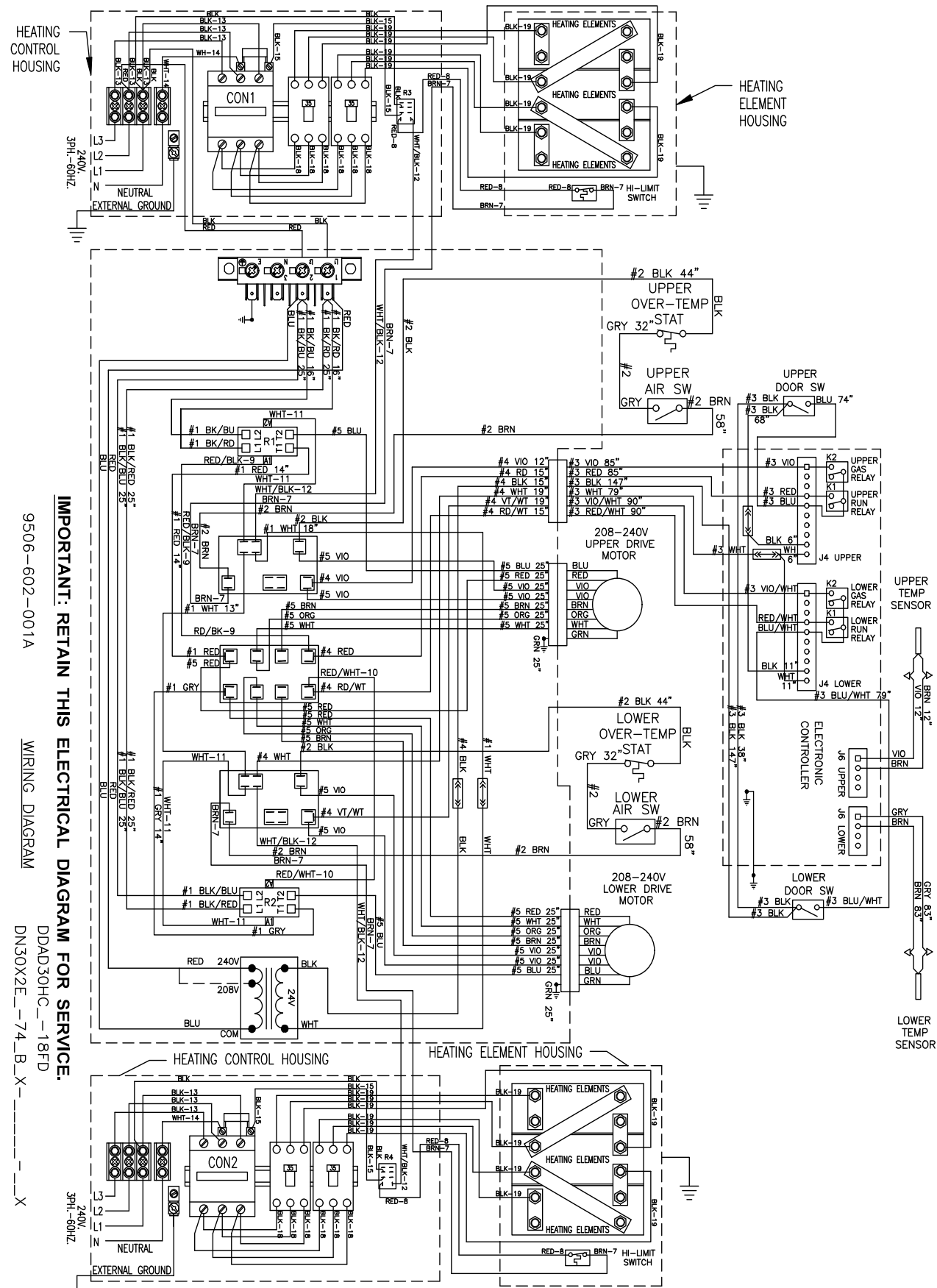

IMPORTANT: RETAIN THIS ELECTRICAL DIAGRAM FOR SERVICE.
 9506-602-001A WIRING DIAGRAM
 DDAD30HC-18FD
 DN30X2E-74_B_X

30Lb Schematic Diagram -77

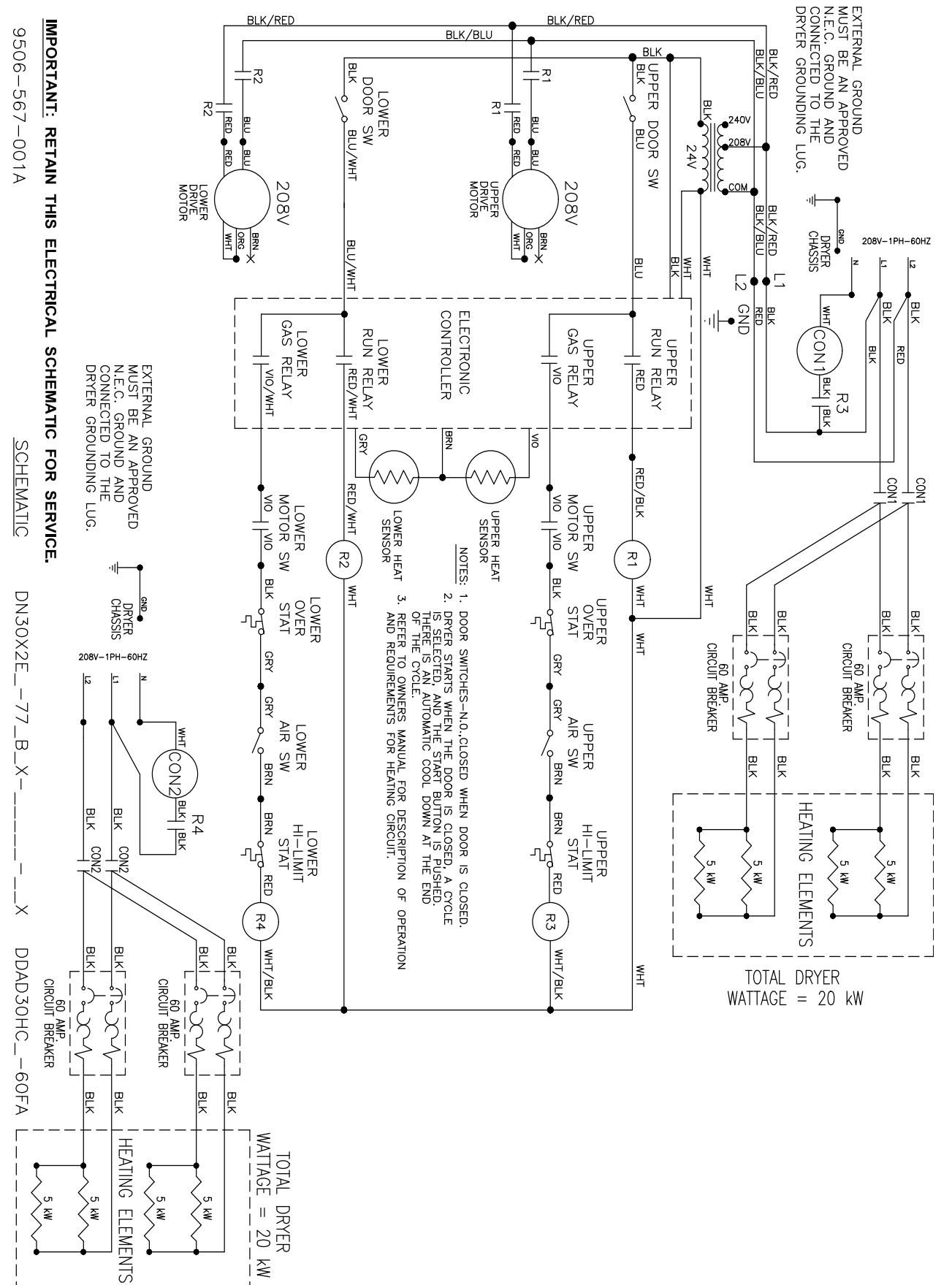

IMPORTANT: RETAIN THIS ELECTRICAL SCHEMATIC FOR SERVICE.
 9506-567-001A SCHEMATIC
 DN30X2E-77_B_X

DDAD30HC-60FA

30Lb Wiring Diagram -77

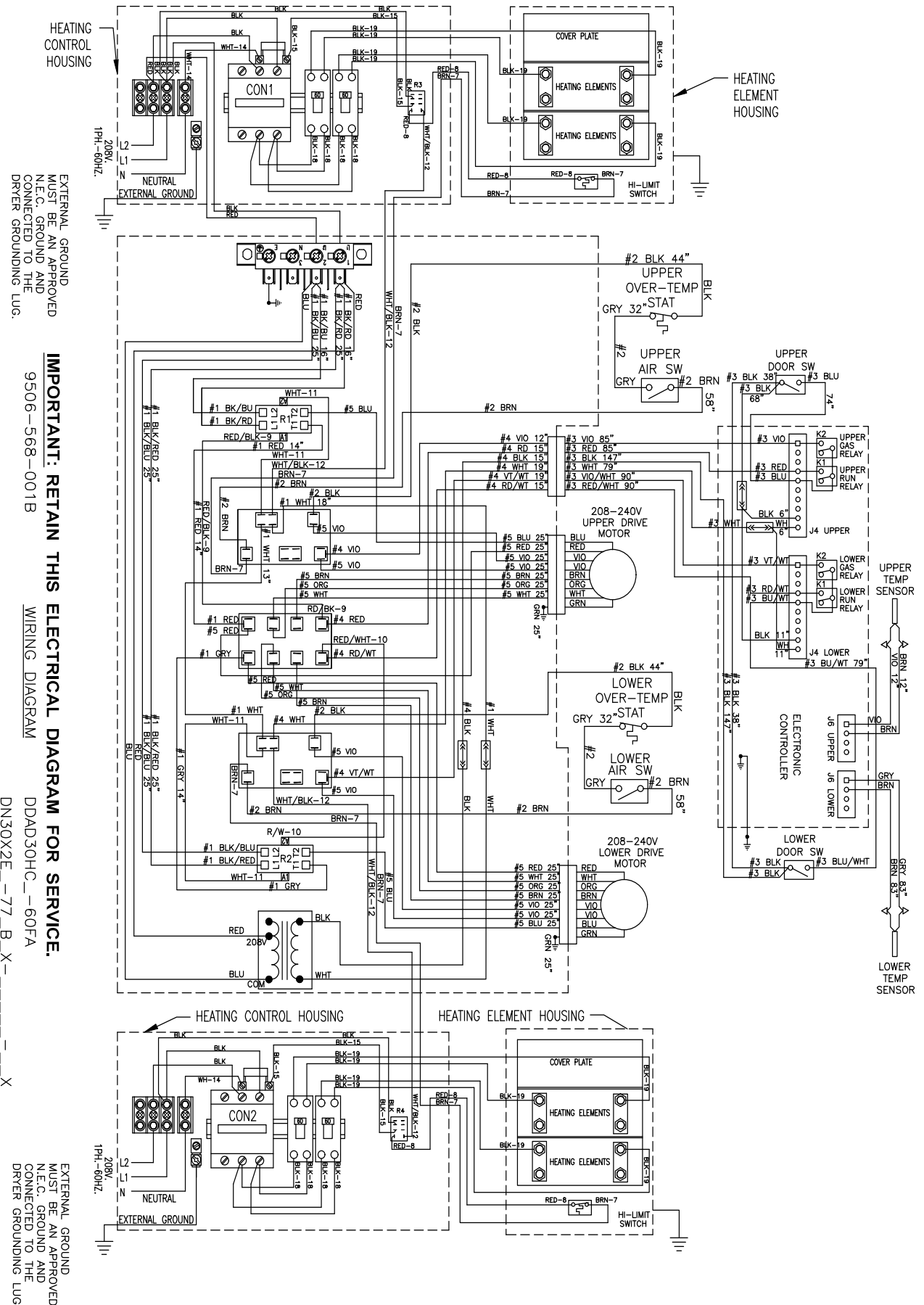

EXTERNAL GROUND MUST BE AN APPROVED N.E.C. GROUND AND CONNECTED TO THE DRYER GROUNDING LUG.

IMPORTANT: RETAIN THIS ELECTRICAL DIAGRAM FOR SERVICE.
9506-568-001B
WIRING DIAGRAM
DDAD30HC-60FA
DN30X2E-77_B_X

30Lb Schematic Diagram -78

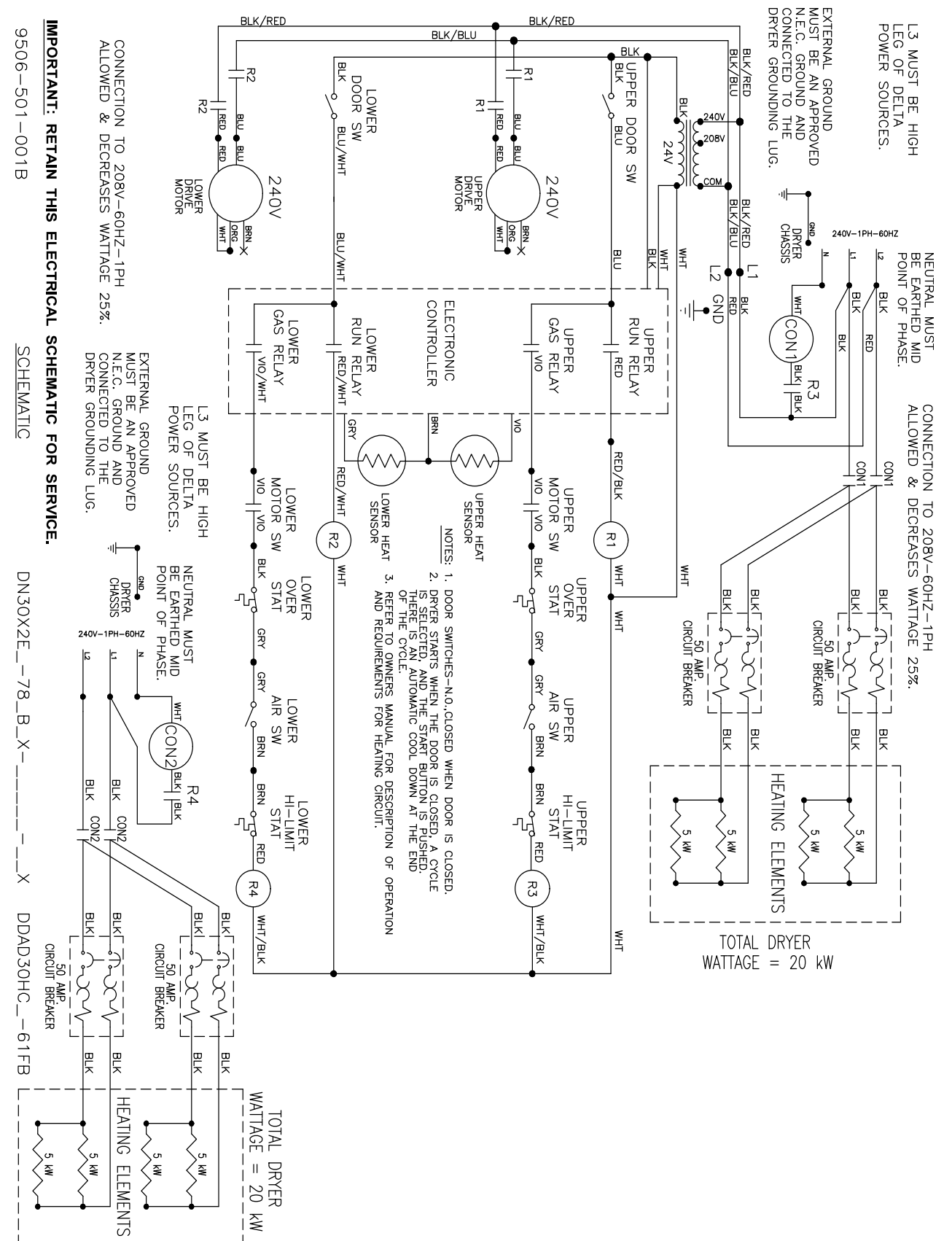

IMPORTANT: RETAIN THIS ELECTRICAL SCHEMATIC FOR SERVICE.
9506-501-001B
SCHEMATIC
DN30X2E-78_B_X

DDAD30HC-61FB
TOTAL DRYER WATTAGE = 20 kW

-59 Models 50 Hz Parts

| Key | Part Number | Description | Quantity |
|-----|--------------|--------------------------------------------------------|----------|
| * | 9558-029-004 | Strip, Terminal Marker -59 Models | 1 |
| * | 9183-030-002 | Filter EMI -59 Models | 1 |
| * | 8711-004-004 | Transformer -59 Models..... | 1 |
| * | 8507-516-001 | Instructions, Transformer Connect -59 Models | 1 |
| * | 9857-140-001 | Ignition Control -59 Models..... | 2 |
| * | 9627-867-001 | Harness-Ignition Control, Upper | 1 |
| * | 9627-867-002 | Harness-Ignition Control, Lower | 1 |
| * | 9631-403-008 | Wire Assembly High Voltage Upper | 1 |
| * | 9631-403-009 | Wire Assembly High Voltage Lower | 1 |
| * | 9376-333-001 | Motor..... | 2 |
| * | 9453-169-015 | Pulley, Motor Drive | 1 |
| * | 9627-864-005 | Harness Motor Extension..... | 2 |
| * | 9506-965-001 | Wiring Label Schematic/Diagram -59 Models..... | 1 |
| * | 9866-007-007 | Lint Drawer Assembly Upper/Lower -59 Models..... | 2 |
| * | 9435-035-001 | Overlay, Lint drawer, Black -59 Models..... | 2 |
| * | 8514-312-001 | Operators Manual -59 Models | 1 |
| * | 8502-748-001 | Do Not Enter/Confined Space Warning Label..... | 2 |
| * | 8502-748-006 | Explosive Material Warning Label | 2 |
| * | 8502-748-007 | Flammable Material Warning Label | 2 |
| * | 8502-748-014 | Frame/Chassis Ground Warning Label | 1 |
| * | 8502-748-003 | Do Not Operate with Guards Removed Warning Label | 3 |
| * | 8502-748-004 | Do Not Operate w Guards Removed Warning Label | 1 |
| * | 8502-748-005 | Electrical Shock/Electrocution Warning Label | 1 |
| * | 8502-748-008 | Lockout Warning Label..... | 1 |
| * | 8502-748-009 | Read Operators Manual Warning Label | 3 |
| * | 8502-748-017 | Hot Surface Warning Label | 2 |
| * | 8502-748-018 | Do Not Touch Warning Label | 1 |
| * | 8502-748-015 | PE Mark (Ext. Protective Guard) Warning Label | 1 |

Section 9:

50Hz

9506-959-001PR

SCHEMATIC

DN(30/50)X2N_59CB_X

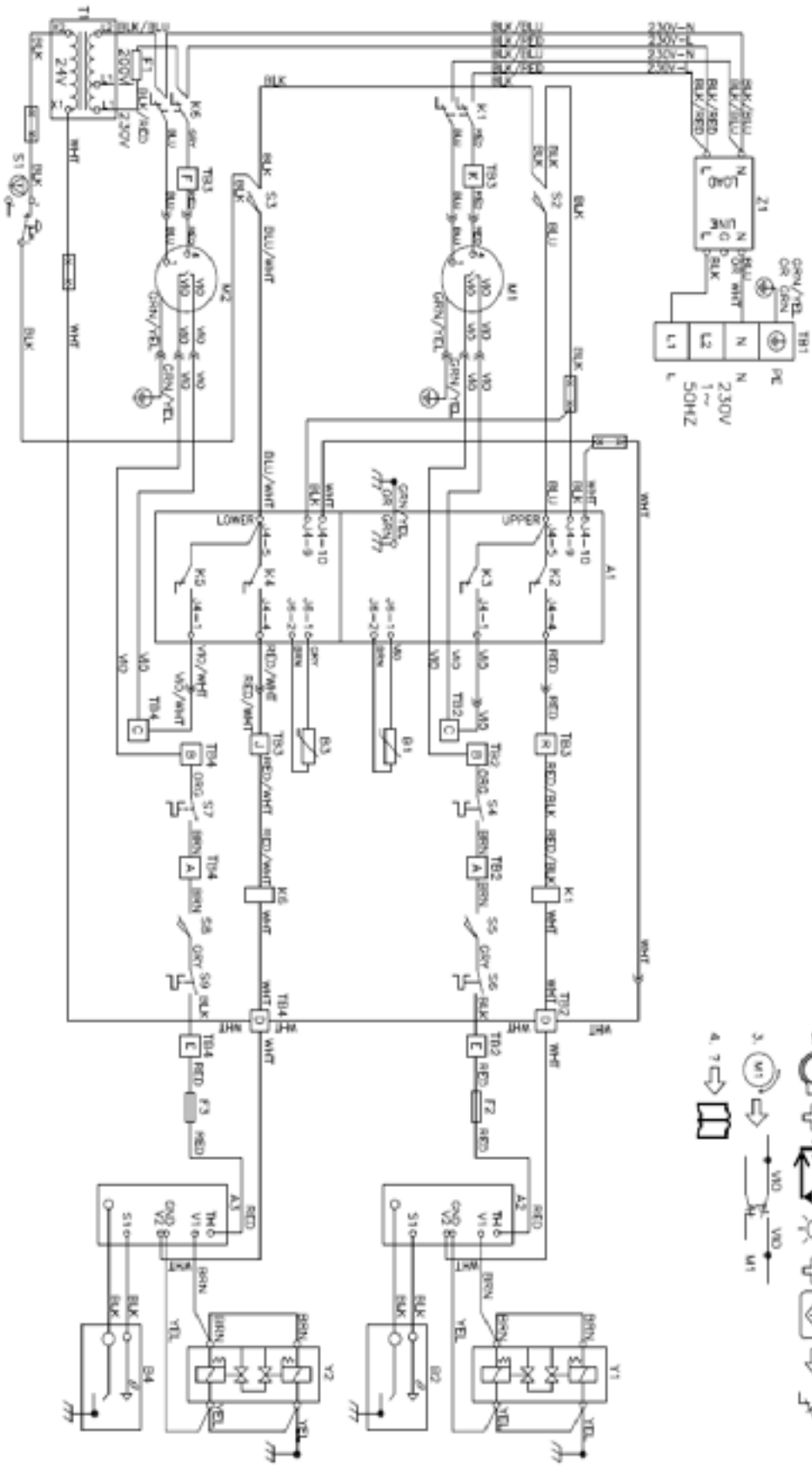

- 1. \Rightarrow S2
- 2. \Rightarrow L
- 3. \Rightarrow M1
- 4. \Rightarrow K4