



***DEXTER***<sup>®</sup>  
***LAUNDRY***

**USE THE BLUE TABS LOCATED ON THE  
RIGHT AND LEFT SIDES OF THE FOLLOWING  
DOCUMENT TO ADVANCE TO EACH SECTION.**



## Cabinet Group by Part #

Key	Part Number	Description	
*	9960-256-021	Door Assy., Loading Complete-Wht.	1
*	9960-256-025	Door Assy., Loading Complete-SS.	1
1	9960-255-007	Door Assy., Loading-SS	1
2	9982-280-002	Plate Assy., Hinge (Wht)	1
2	9982-280-011	Plate Assy., Hinge (SS)	1
*	9545-012-015	Screw, Hinge to Door	4
*	8640-413-002	Nut, Hinge to Door	4
3	9212-002-003	Glass, Door	1
4	9206-164-009	Gasket, Glass	1
*	9548-1 17-000	Support, Door Glass (inside gasket)	1
5	9206-420-002	Gasket, Outer Rim	1
6	9244-082-001	Handle, Loading Door	1
*	9545-018-017	Screw, Handle	2
*	9531-033-001	Stud, Door Catch	1
*	9086-015-002	Catch, Loading Door	1
*	8640-413-003	Acorn Nut, Hex	1
7	9454-694-007	Panel Assy., Front- white	1
7	9454-694-001	Panel Assy., Front-S. Steel.	1
*	8640-413-001	Nut Hex #10-32	1
8	9108-102-002	Door, Upper Service-S.S	1
8	9108-102-006	Door, Upper Service-White	1
9	9578-091-003	Trim, Door-Upper Service	1
10	8650-006-003	Lock, Upper Service	1
*	6292-006-006	Key-Only Service Lock	1
*	8638-211-001	Rivet, Drive	2
*	8641-581-005	Washer, Flat.	2
*	9548-243-002	Support, Upper Door	1
11	9412-083-001	Nameplate, DEXTER Commercial Dryer	1
12	9545-012-003	Screw, Chrome	4
*	8641-436-000	Washer, Fiber	4
*	8641-582-019	Lockwasher	10
*	8640-399-001	Nut, Spring	6
13	9544-047-002	Strap, Hinge (White)	1
13	9544-047-007	Strap, Hinge (Gray)	1
*	9545-008-009	Screw, Hinge to Panel.	4
14	9545-052-001	Screw, Door to Hinge Strap	1
*	8641-436-004	Washer, Fiber.	1
15	9960-262-001	Door Ass'y, Lower Service-SS	1
15	9960-262-003	Door Ass'y, Lower Service-White	1
16	9578-088-002	Trim, Door - Lower Service	1
17	9545-008-021	Screw, Pn Hd Cr., #10x1/2	5
18	9578-084-003	Trim, Kick- Lower Service Door	1
19	9545-008-010	Screw,Tr Hd Cr #10x1/2Blk	3
20	8650-026-001	Latch, Lower Door (Thumbtum)	1
*	8544-005-000	Leg, Leveling	4
*	9812-012-001	Outer Baffle, Cabinet- Left	1
*	9812-012-002	Outer Baffle, Cabinet- Right.	1
*	9545-008-003	Screw, #10x1/2	8
21	9074-276-001	Cover, Cabinet	1
22	9545-008-024	Screw #10 AB x 3/8	10

\* Not Illustrated

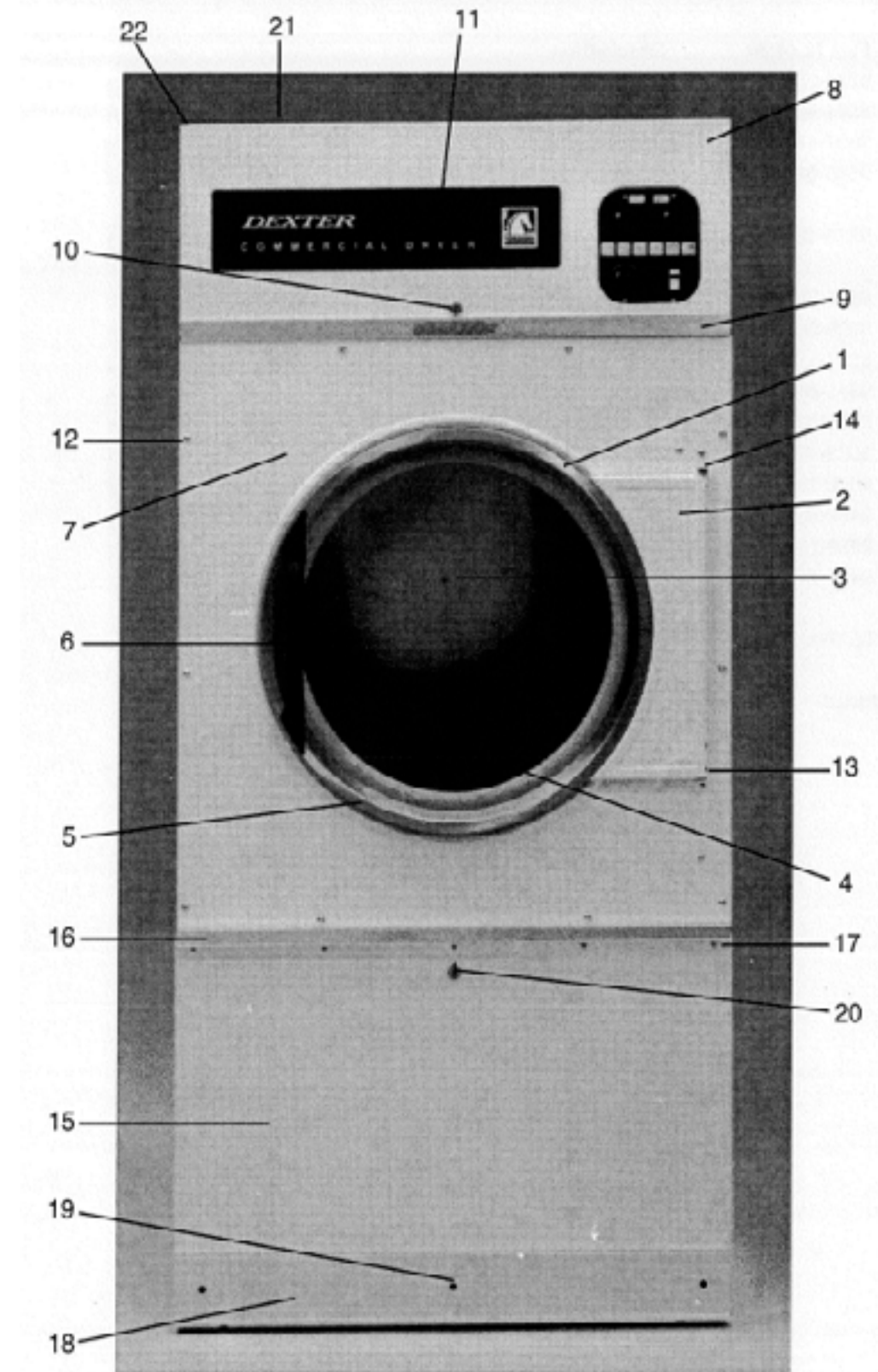



## Drive Group by Part #

Key	Part Number	Description	Qty
1	9376-300-001	Motor, Drive.	1
*	9732-205-007	Motor Replacement Kit	1
*	9545-014-004	Screw, Hx 5/16	4
*	8640-400-003	Nut.	4
2	9453-169-010	Pulley, Motor	1
*	9545-028-013	Screw, Set.	2
3	9991-054 004	Support Ass'y, Motor	1
4	9545-014-004	Screw	4
4	8640-419.-003	Nut.	4
*	9278 038-004	Impeller	1
*	9074 277-001	Cover, Impeller	1
*	9545-008-001	Screw, Hx #10 x 1/4	4
5	9991-053-001	Support Ass'y, Intermed. Pulley	1
6	9545.:029-010	Bolt, Rd Hd	3
7	9545-029-003	Screw	1
8	8640-tl 5-004	Nut.	3
*	8641-581-035	Washer, Flat	4
*	9861-024-003	Arm Ass'y-Tension Complete from Serial Number #12816	1
9	9861-024-001	.Arm Ass'y-Tension, Complete	1
*	8641-581-035	Washer, Flat	6
*	9487-200-003	Ring-Retaining	2
*	9908-042-006	Pulley Ass'y Intermediate Use After Serial Number #124816	1
10	9732-165-001	Pulley Ass'y, Intermediate Kit Complete w/ Tension Arm	1
*	9036-159-007	Bearing, Ball-Idler Pulley	2
*	9538-173-001	Spacer, Bearing	1
*	8641-581-035	Washer, Flat.	6
*	9487-200-003	Ring, Retaining	2
11	9908-043-002	Pulley Driven	1
*	9487-234-001	Ring, Tolerance	1
12	8641-581-026	Washer, Flat	1
*	8641-582-016	Lockwasher	1
13	9545-017-009	Screw, Hx Cap	1
14	9040-077-005	Belt, Final Drive	1
15	9040 077-003	Belt, Motor Drive	,1
16	9534-151-000	Spring, Belt Tension	1
17	9099-012-002	Chain, Spring Tension	1
18	9248-022-001	Hook, Tension	1
*	9208-051-001	Guard, Drive	1
*	9454-692-001	Panel, Drive Guard, RH	1
*	9454-693-001	Panel, Drive Guard, LH	1
*	9550-175-001	Shield, Motor	1
*	9545-008-003	Screw	2
*	9545-008-024	Screw	32

\*Not illustrated

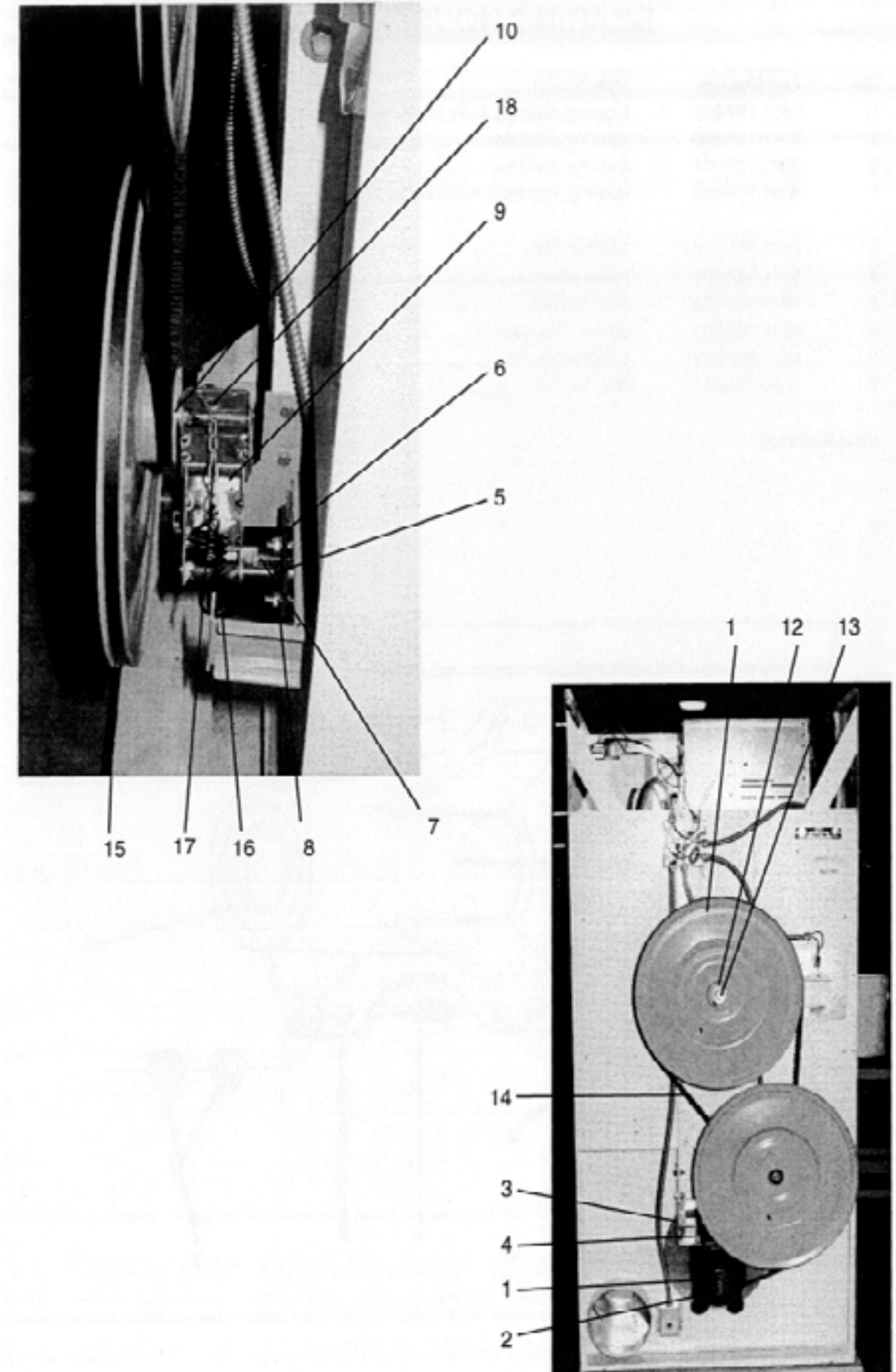

## Door Switch Group by Part #

Key	Part Number	Description	Qty
1	9041-076-001	Box, Door Switch	1
2	9550-159-001	Shield, Poor Switch	1
3	9539-461-001	Switch, Door	1
4	8640-401-001	Nut, Special Twin	1
5	9545-020-001	Screw, Pn Hd Sl.#4-40 x 3/4	2
6	9074-255-001	Cover, Switch Box	1
7	9545-008-020	Screw, Box Cover	2
8	9008-004-001	Actuator, Switch- Lower	1
9	6068-041-001	Conduit.	1
10	9545-012-003	Screw	2
*	8641-436-000	Washer, Fiber	1
11	8640-413-004	Nut, Elastic Stop	2

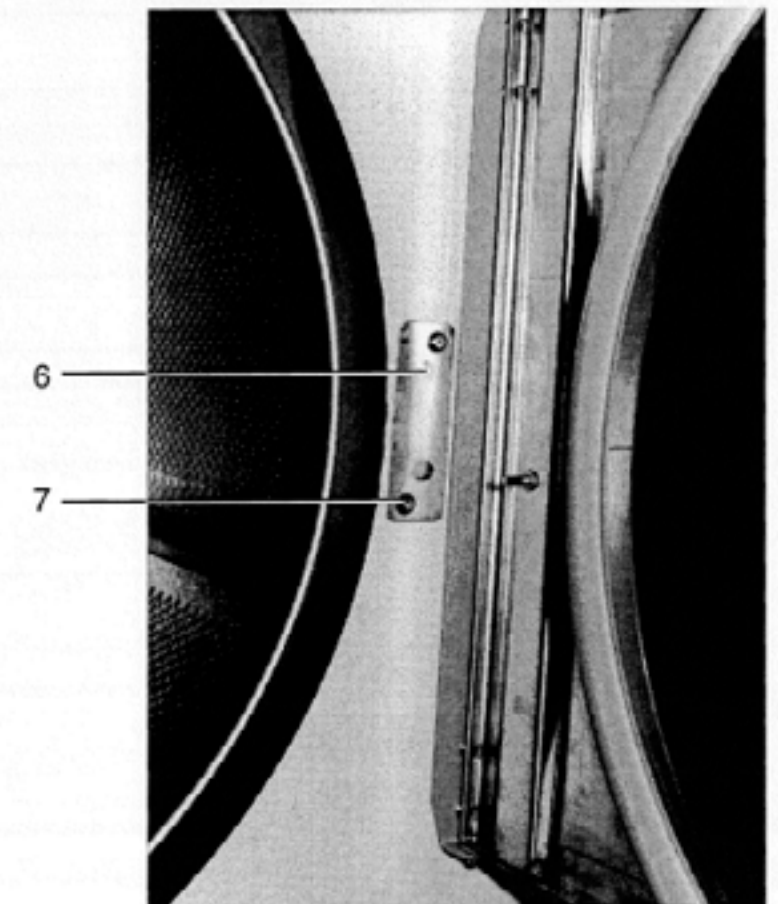
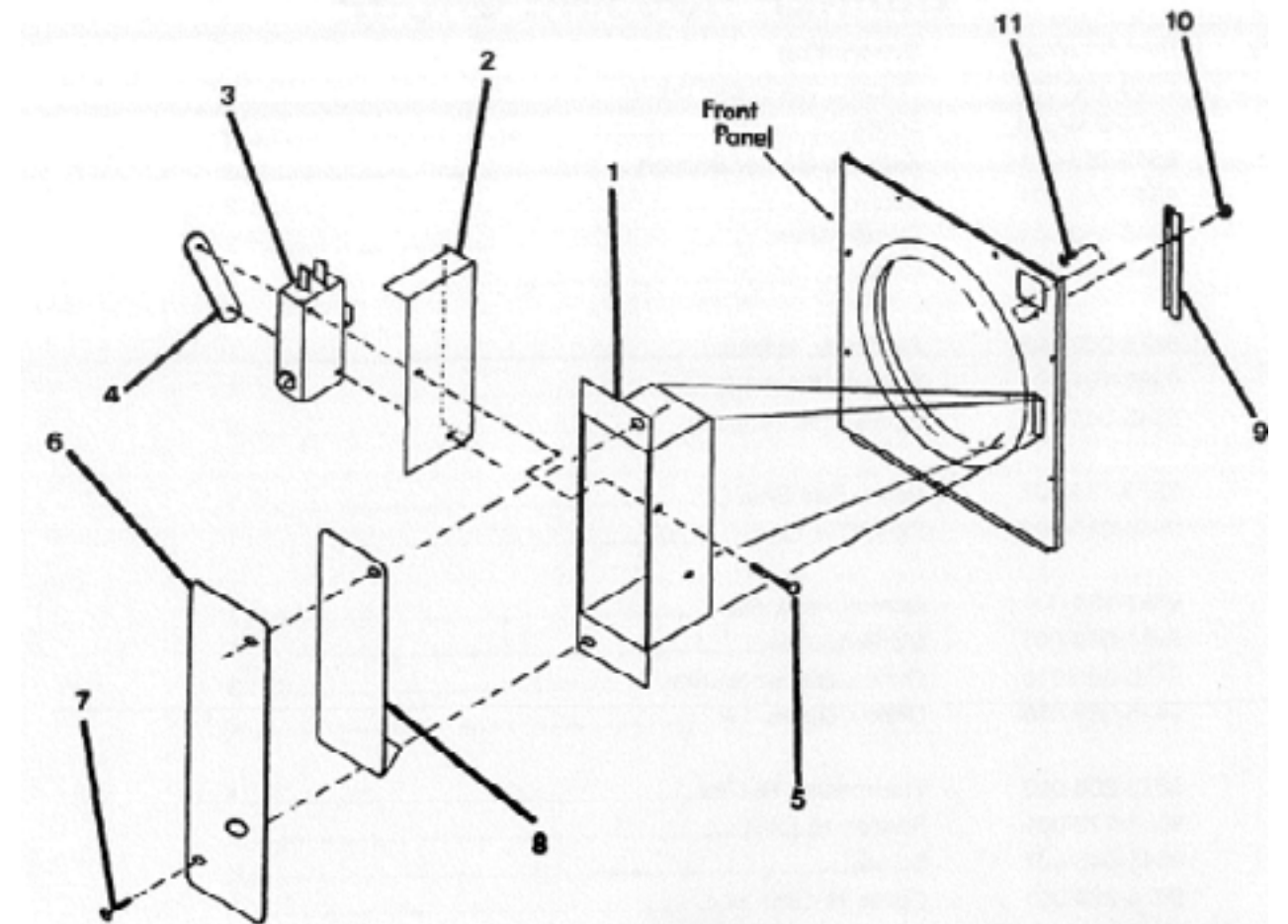

## Burner Housing Group by Part #

Key	Part Number	Description	Qty
1	9803-163-003	Housing Assembly, Burner	1
*	9545-008-024	Screw	4
*	9548-256-001	Support, Burner	1
*	9545-045-001	Screw	2
2	9048-018-001	Burner, Main	2
*	9545-045-001	Screw	4
3	9875-002-002	Electrode, Ignition	1
4	9985-161-001	Bracket, Electrode Mtg	1
*	9545-045-001	Screw, Electrode Mtg	2
5	9379-164-001	Valve, Gas Shut Off	1
*	9458-020-003	Pipe, Gas Line	1
6	9857-134-001	Control Assy, Gas	1
7	9381-009-001	Manifold, Assy	1
*	9425-069-015	Orifice, Burner-Natural	2
*	9425-069-016	Orifice, Burner-LP	2
8	9576-203-002	Thermostat, Hi-Limit	1
*	9538-142-001	Spacer, Hi-Limit	2
*	9545-045-007	Screw	2
9	9074-234-001	Cover, Hi-Limit Stat	1
*	9545-008-024	Screw	1
10	9857-116-002	Control, Ignition	1
*	9545-044-002	Screw	2
*	8640-411-003	Nut, Hex Keps	2
11	9897-026-001	Terminal Block	1
*	9545-031-004	Screw	2
12	9631-403-003	Wire Assy, High Voltage	1
*	9627-711-001	Harness, Low Voltage Ignition	1
13	9054-045-001	Fuseholder	1
14	8636-018-001	Fuse	1
15	8711-002-001	Transformer, Control.	1
*	9545-008-026	Screw, #10 x 3/8	2
*	9732-102-005	Kit, LP Conversion	1

\* Not Illustrated

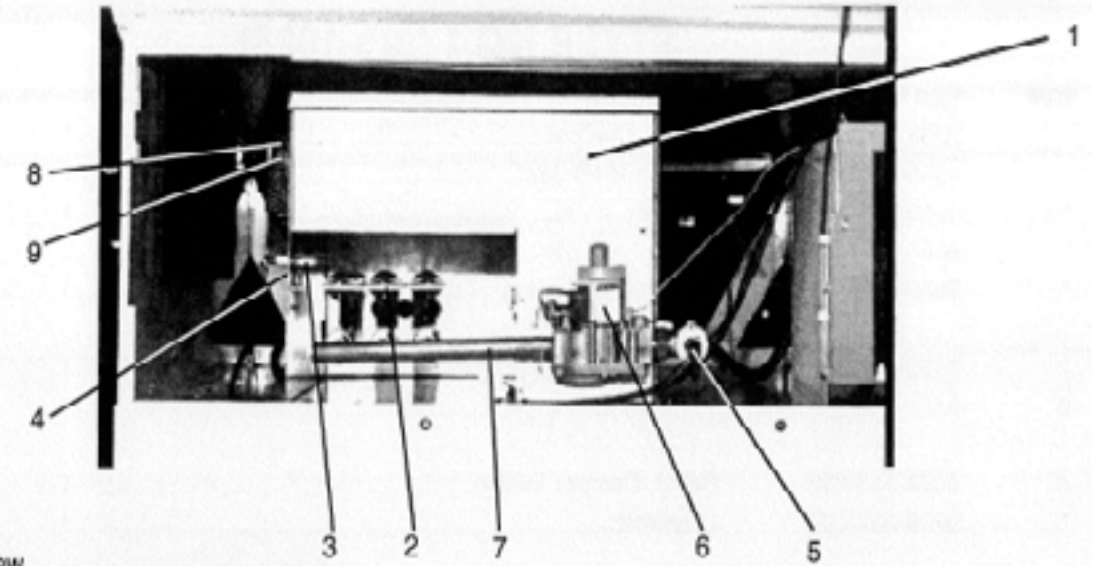

Rear View

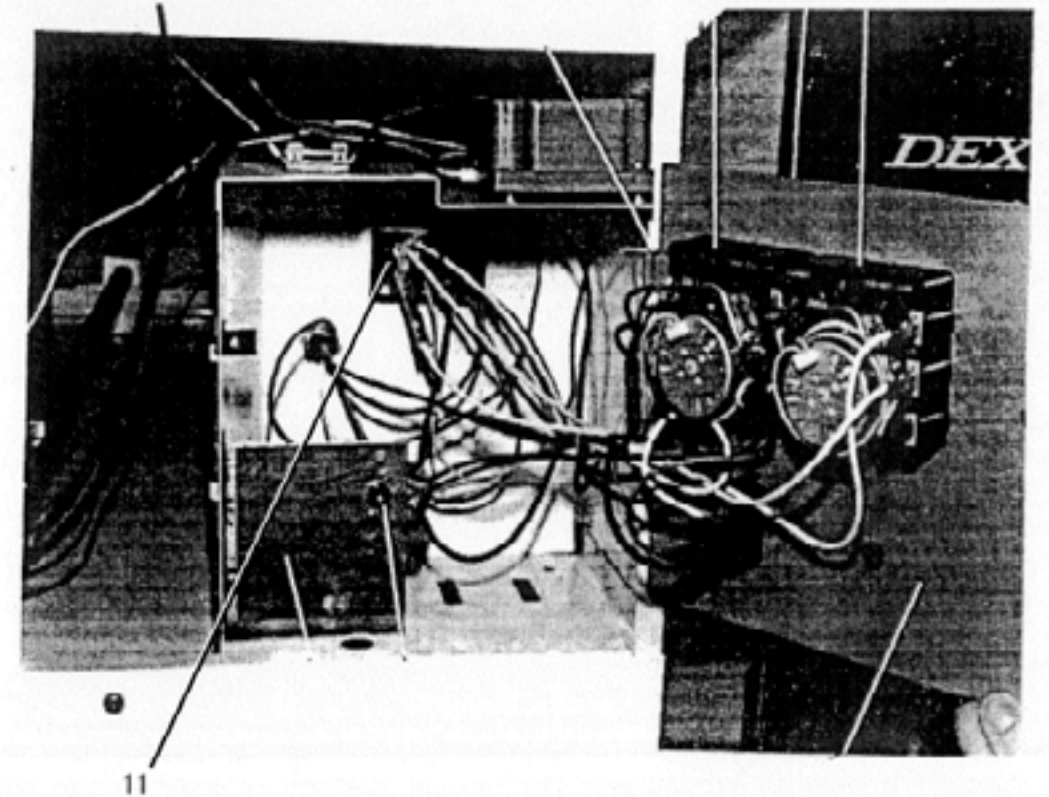
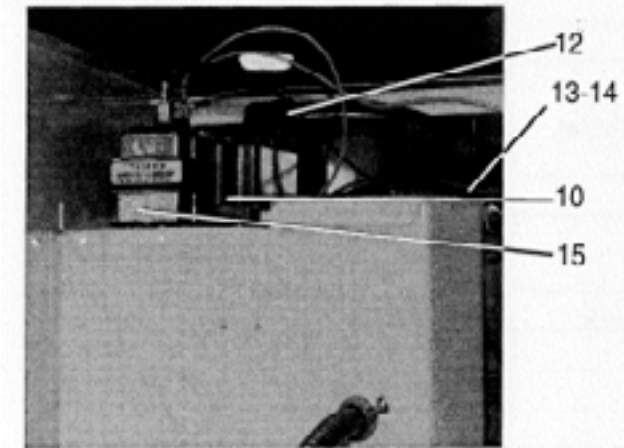

## Bearing Housing Group by Part #

Key	Part Number	Description	Qty
*	9803-189-001	Housing, Bearing Ass'y (includes #1 and #2)	1
1	9241-183-003	Housing, Bearing	1
2	9036-159-001	Bearing, Ball-Rear	1
*	9036-159-002	Bearing, Ball-Front Sold on Spider	1
3	8641-581-026	Washer, Flat.	4
4	8641-582-004	Lockwasher	4
5	9545-017-004	Bolt, 1/2-13x1	4
6	9545-059-003	Screw, 7 1/16 -14x1 1/2	2
*	8641-582-013	Lockwasher, 7 1/6	2
7	8640-416-001	Nut, 7/16 - 14	4

\* Not Illustrated

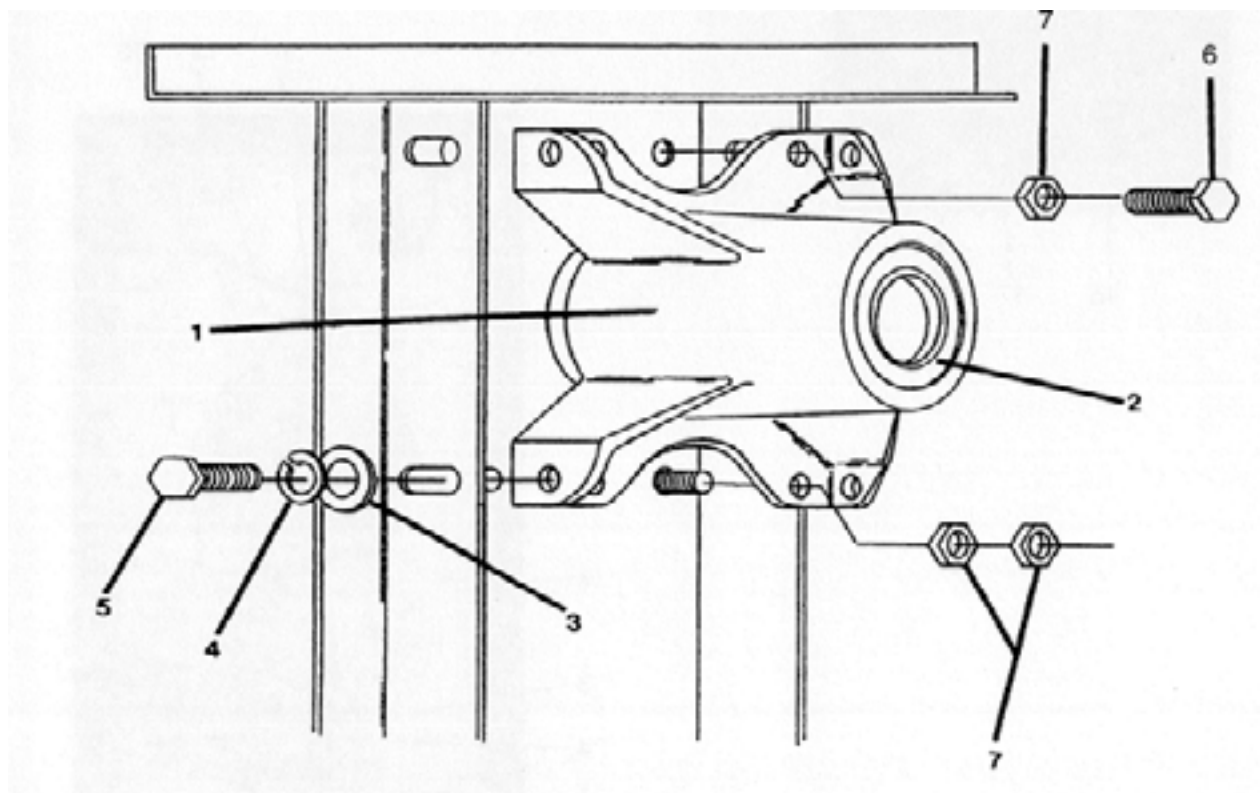

## Tumbler Group by Part #

Key	Part Number	Description	Qty
1	9848-119-001	Tumbler Ass'y.	1
2	9873-005-001	Spider Ass'y w/ bearing on	1
3	9497-226-001	Rod, Tumbler	4
4	8640-417-002	Nut	4
5	9552-013-000	Shim	4
6	8641-582-004	Washer, Spring Lock	4
7	8641-587-001	Washer, Tumbler Rod Special	4
*	9487-234-001	Ring, Tolerance	1
8	8641-582-016	Lock Washer, Tumbler Shaft	1
9	8641-581-026	Flat Washer, Tumbler Shaft	1
10	9545-017-009	Screw, Tumbler Shaft.	1

\* Not Illustrated

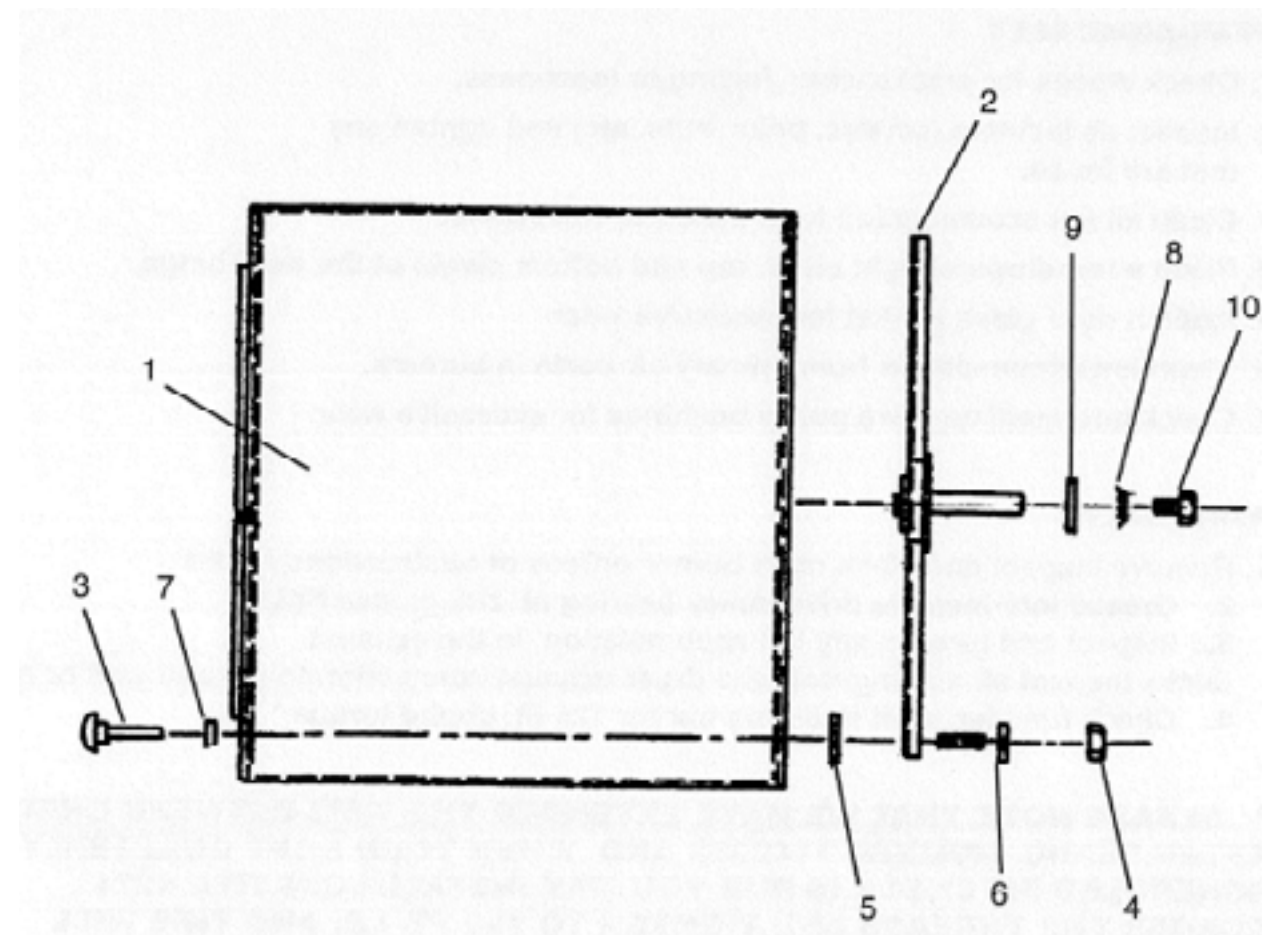



## Damper Switch, Lint Hood, & Blower Impeller Group Style No. 1 (in use since 1998)

Key	Part Number	Description	Qty
1	9539-432-001	Switch, Damper	1
*	9545-044-002	Screw, Hx #6-32x1	1
*	8640-411-003	Nut, Hex #8-32	1
*	9545-044-002	Screw, Hx 6-32x1	2
*	8640-420-001	Nut, Speed Tandem	1
2	9125-001-001	Damper	1
3	9451-146-001	Pin, Damper Hinge	1
4	9074-242-002	Cover, Damper Switch	1
*	9209-037-002	Grommet.	1
5	9834-008-002	Hood Ass'y, Lint	1
6	8640-412-004	Nut, Whizlock	6
*	9822-031-001	Lint Screen 21"x36" (old style)	1
7	9576-207-006	Thermostat, Safety	1
*	9545-008-001	Screw, Hx. #10 x 1/4	2
8	9539-461-001	Switch, Lower Door	1
9	9029-092-001	Bracket, Lower Door Switch	1
*	9545-008-024	Screw	2
10	9278-038-004	Impeller, w/set screws	1
*	9345-836-003	Schematic Wiring	1
*	9345-837-003	Diagram Wiring	1

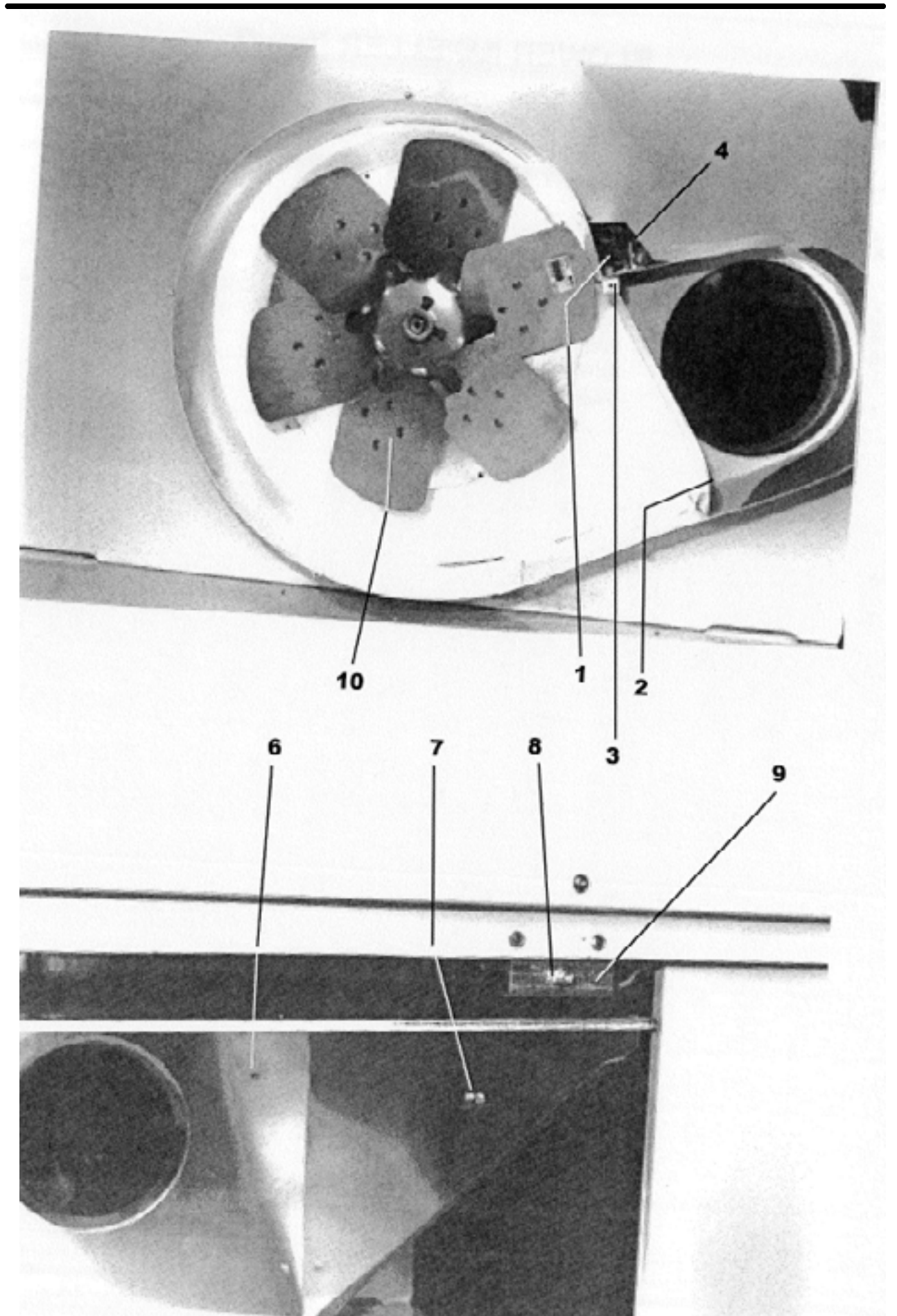

Lint Hood, & Blower Impeller Group  
 Style No. 2 (in use since 1998)

Key	Part Number	Description	Qty
1	9822-031-002	Lint Screen Ass'y 21"x34"	1
2	9278-038-004	Impeller	1
3	9834-010-001	Hood assembly Lint	1
*	9345-836-004	Schematic Wiring	1
*	9345-837-004	Diagram Wiring	1

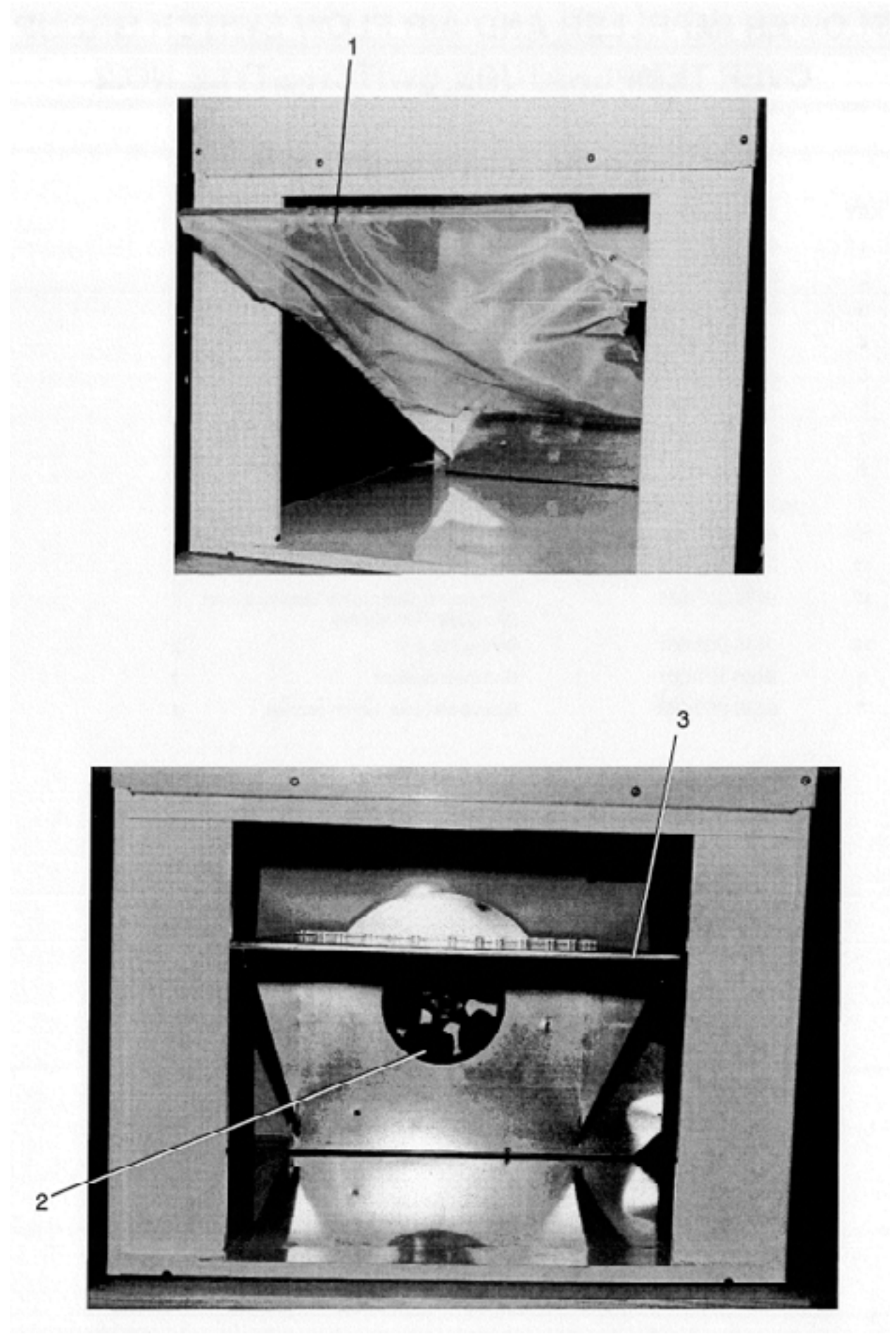

## Blower Impeller and Airflow Switch Group Overtemperature Switch Style No. 2 (in use after 1998)

Key	Part Number	Description	Qty
1	9074-283-001	Cover Plate	1
2	9029-046-001	Actuator Stop	1
3	9029-100-001	Bracket -Switch	1
4	9545-008-001	Screw-JOB .x ¼	4
5	9539 461-009	Switch-Micro	1
6	9545 020-001	Screw 4-40 x %	2
7	8640-401-001	Nut Twin	1
8	9008-007-001	Actuator-Switch	1
9	9451-169-002	Pin Cotter	1
10	9039-575-000	Bracket Conduit	1
11	9825-057-002	Over-temp cover ass'y	1
12	9576-207-006	Thermostat Over-temp Manual Reset (Manually Resettable)	1
13	9545-008-001	Screw 108 x ¼	2
*	9486-137-001	Retainer; pushon	1
*	9535-050-003	Sleeve-Hi-Limit switch access	1

